

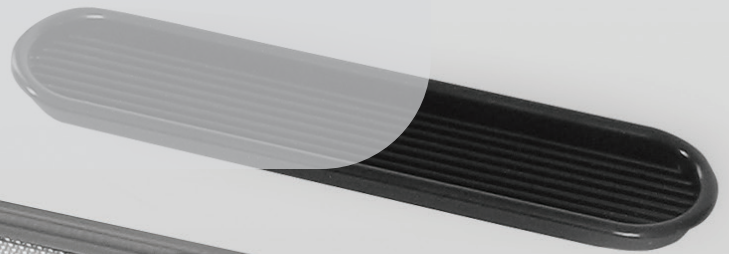

MISCELLANEOUS

CABLE GROMMETS
VENTILATORS
BATHROOM ACCESSORIES
MULTI-PURPOSE DOORS, LIDS
TOWEL BARS, RACKS

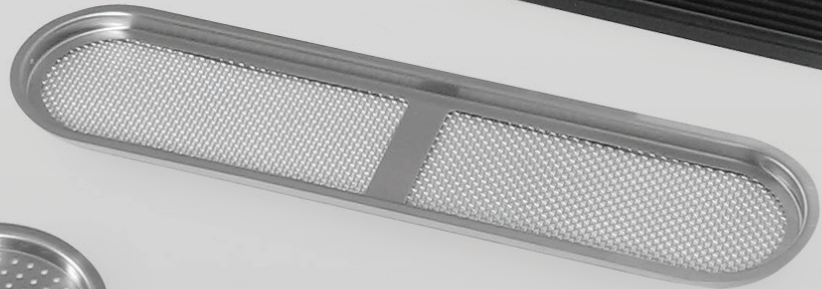

VENTILATORS

Picture	Item No.		Page
	SAM	NSF COMPONENT, RoHS Compliant, STAINLESS 304 STEEL	672
	SAD	NSF COMPONENT, RoHS Compliant, STAINLESS 304 STEEL	672
	ASM	RoHS Compliant, STAINLESS 304 STEEL	672
	ASD	RoHS Compliant, STAINLESS 304 STEEL	673
	AST	RoHS Compliant, STAINLESS 304 STEEL	673
	AST-160, 210	RoHS Compliant, STAINLESS 304 STEEL	673
	1-1122	STAINLESS 316 STEEL	674
	1-1212	STAINLESS 316 STEEL	674
	1-2211	STAINLESS 316 STEEL	675
	1-2222	STAINLESS 316 STEEL	675
	APK, APKL	RoHS Compliant	676
	APD, APDL	RoHS Compliant	676
	APD-KH		677
	APM		678
	APB		678

CABLE GROMMETS

Picture	Item No.		Page
	S445, S51, S60, S76, S89	RoHS Compliant	679
	S165-76	RoHS Compliant	679
	V60, V80	RoHS Compliant	680
	V2000	RoHS Compliant	680
	LSU, LS		681
	CHC		681
	LN72D		682
	LN72S		682

BATHROOM ACCESSORIES				MULTI-PURPOSE DOORS, LIDS & GROMMETS			
Picture	Item No.		Page	Picture	Item No.		Page
	ZL-3201 (TOWEL BAR)		683		AZ-GD231-HL	 	689
	ZL-3202 (TOWEL BAR)		683		AZ-GD232-HL	 	689
	KB-T (TOWEL BAR)		684		AZ-GD	 	690
	DSR-01/18 (TOWEL BAR)	 	684		AZ-SLP	 	691
	DST-06 (TOWEL BAR)	 	685		AZ-HD230/HL, AZ-HD310/HL	 	691
	DSR-02 (TOWEL BAR)	 	685		AD-KH	 	692
	DSR-08 (TOWEL RACK)	 	686		AN-KH	 	692
	DSD-80 (TOWEL RACK)	 	686		AD-GD	 	693
	DSB-01 (TOILET PAPER HOLDER)	 	687		AD-DH015-HL	 	693
	DSB-03 (TOILET PAPER HOLDER)	 	687		AN-DH020		694
	DSB-04 (TOILET PAPER HOLDER)	 	687		AZ-DD310/HL	 	694
	DSB-09 (TOILET BRUSH/HOLDER)	 	688		AZ-ND	 	694
	DSB-07 (TOILET PAPER HOLDER)		688		AN-DH, AN-LH	 	695

VENTILATOR



SAM

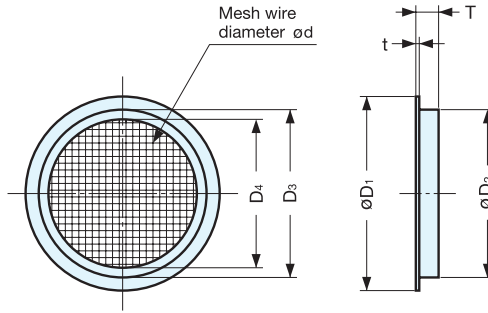

- 0.4 mm mesh wire diameter.
- Affix with glue.

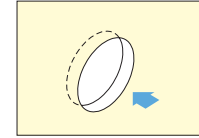

Installation

Material	Finish
304 Stainless Steel	Satin

Item No.	D ₁	D ₂	D ₃	D ₄	T	t	d	Weight (g)	Box (pcs)	Carton (pcs)
SAM- 37	36 (1-27/64")	31.5 (1-1/4")	30.0	25	5.2	0.3	0.4	4.5	70	1400
SAM- 45	46 (1-13/16")	41.5 (1-41/64")	40.0	35	5.2			6.0	60	1200
SAM- 60	60 (2-23/64")	53.5 (2-7/64")	52.0	46	6.5			9.5	50	1000
SAM- 85	85 (3-11/32")	77.8 (3-1/16")	76.5	68	7.0			16.5	30	600
SAM- 120	120 (4-23/32")	110.5 (4-23/64")	108.0	99	7.2	0.5		46.5	20	200

VENTILATOR



SAD

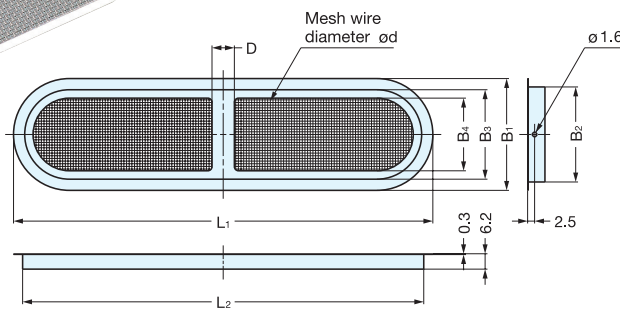
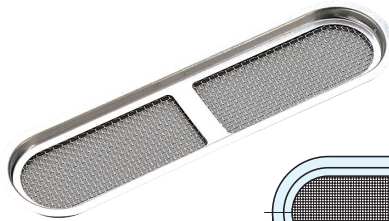

- 0.4 mm mesh wire diameter.
- Affix with glue or tack.

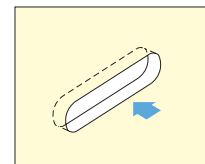

Installation

Material	Finish
304 Stainless Steel	Satin

Item No.	L ₁	B ₁	B ₃	B ₄	L ₂	B ₂	D	d	Weight (g)	Box (pcs)	Carton (pcs)
SAD-150	150.0 (5-29/32")	40 (1-37/64")	32	26	143.5	34	8	0.4	18.5	30	600
SAD-200	200.5 (7-57/64")	50 (1-31/32")	42	35	194.0	44	10		30.0		300

VENTILATOR



ASM

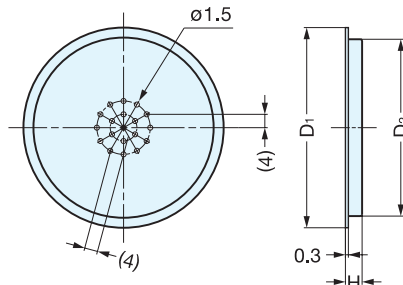

- 1.5 mm (1/16") diameter holes.
- Affix with glue.

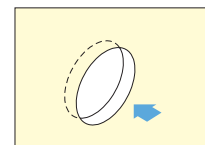

Installation

Material	Finish
304 Stainless Steel	Satin

Item No.	D ₁	D ₂	H	Holes	Weight (g)	Box (pcs)	Carton (pcs)
ASM-37	36 (1-27/64")	31 (1-7/32")	4.5	37	3.0	100	3600
ASM-45	46 (1-13/16")	41 (1-39/64")		59	5.0		
ASM-60	60 (2-23/64")	53 (2-3/32")	127	8.0			
ASM-85	85 (3-11/32")	77 (3-1/32")	5	271	13.5	50	1000

VENTILATOR



ASD

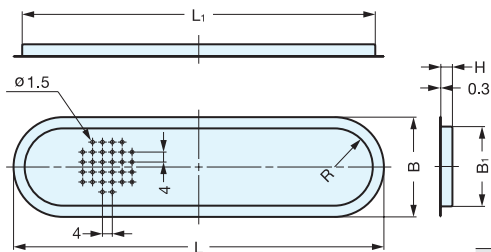
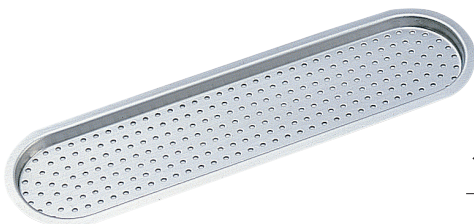

- 1.5 mm (1/16") diameter holes.
- Affix with glue.

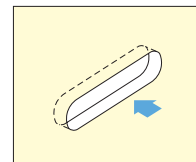

Installation

Material	Finish
304 Stainless Steel	Satin

Item No.	L	L ₁	H	B	B ₁	R	Holes	Weight (g)	Box (pcs)	Carton (pcs)
ASD-150	150 (5-29/32")	143	5	40 (1-37/64")	33.0	16	268	14.5	80	1920
ASD-200	200 (7-7/8")	193		50 (1-31/32")	42.8	21	450	23.0	40	960

VENTILATOR



AST

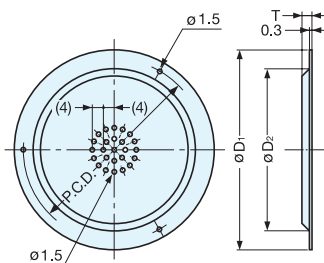

- 1.5 mm (1/16") diameter holes.
- Supplied with tacks.

Material	Finish
304 Stainless Steel	Satin

Item No.	D ₁	D ₂	T	P.C.D.	Holes	Weight (g)	Box (pcs)	Carton (pcs)
AST-45	45 (1-25/32")	34 (1-11/32")	3	40	37	4	100	3600
AST-55	55 (2-5/32")	44 (1-47/64")		50	59	5		
AST-70	70 (2-3/4")	55 (2-5/32")		64	127	9		
AST-100	100 (3-15/16")	81 (3-3/16")	4	91	271	19	50	500

VENTILATOR



AST-160, 210

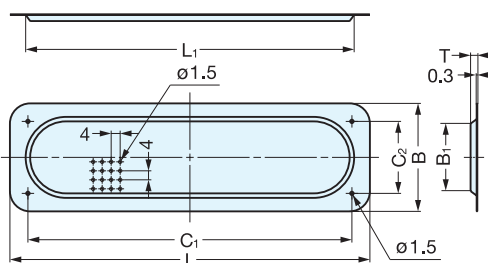

- 1.5 mm (1/16") diameter holes.
- Supplied with tacks.

Material	Finish
304 Stainless Steel	Satin

Item No.	L	L ₁	B	B ₁	C ₁	C ₂	T	Holes	Weight (g)	Box (pcs)	Carton (pcs)
AST-160	160 (6-19/64")	146	48 (1-57/64")	36	144	32	3	268	18	50	1000
AST-210	210 (8-17/64")	196	58 (2-9/32")	46	194	42	4	450	28		200

VENTILATOR



1-1122

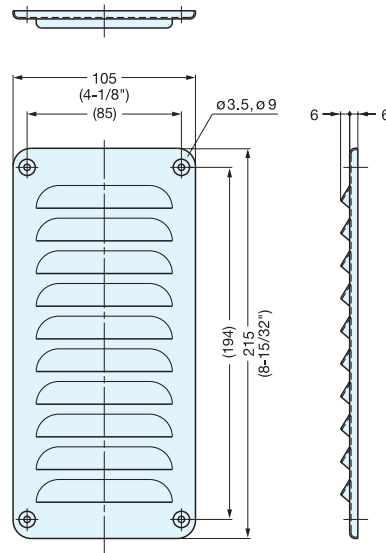

Item No.	Weight (g)	Box (pcs)	Carton (pcs)	Material	Finish
1-1122	165	10	100	316 Stainless Steel	Satin

VENTILATOR



1-1212

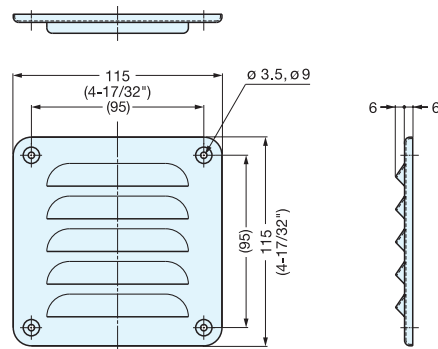

Item No.	Weight (g)	Box (pcs)	Carton (pcs)	Material	Finish
1-1212	165	10	100	316 Stainless Steel	Satin

VENTILATOR



1-2211

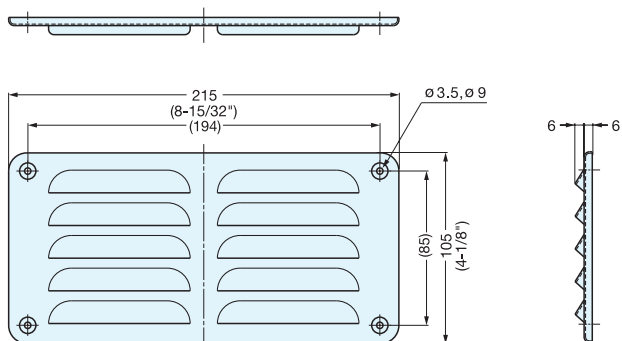

MISCELLANEOUS

VENTILATORS

Item No.	Weight (g)	Box (pcs)	Carton (pcs)	Material	Finish
1-2211	165	10	100	316 Stainless Steel	Satin

VENTILATOR



1-2222

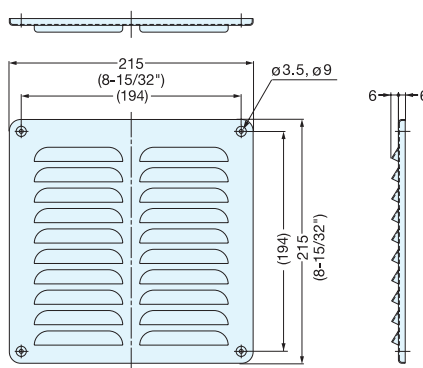

Item No.	Weight (g)	Box (pcs)	Carton (pcs)	Material	Finish
1-2222	295	10	100	316 Stainless Steel	Satin



APK, APKL

VENTILATOR

MISCELLANEOUS

VENTILATORS

• ABS ventilator.

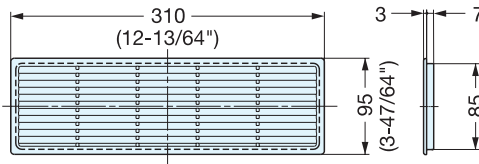
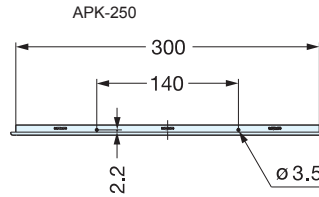
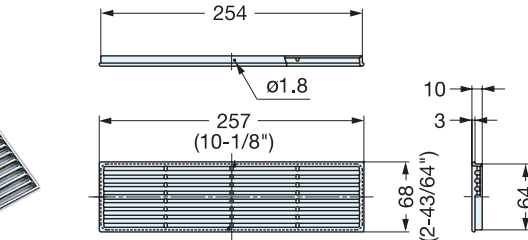
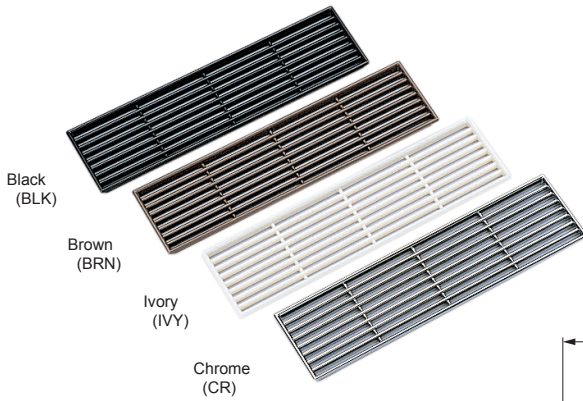

APKL-310

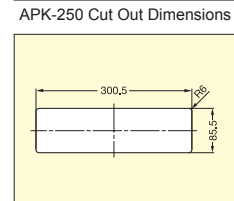
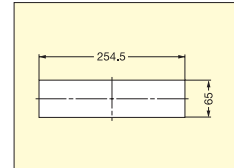

APKL-310 Cut Out Dimensions

Please specify the finish when ordering.

Item No.	Weight (g)	Box (pcs)	Carton (pcs)
APK -250	57	20	160
APKL -310	100	10	80

Material	Finish
ABS	Black (BLK), Brown (BRN), Ivory (IVY), Chrome (CR)-APK-250 type only

VENTILATOR



APD, APDL

• ABS ventilator.

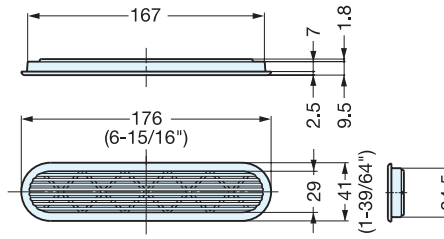
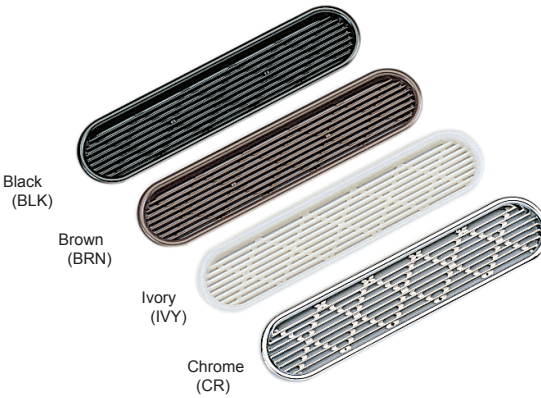

APD-170

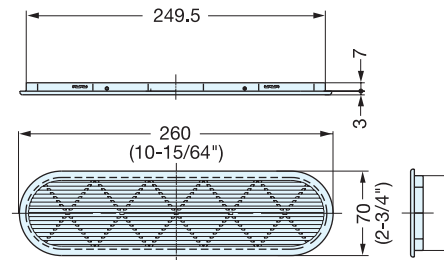

APDL-260

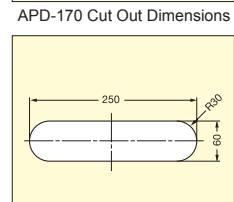
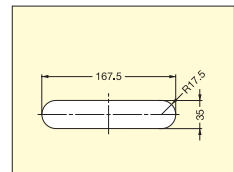

APDL-260 Cut Out Dimensions

Please specify the finish when ordering.

Item No.	Weight (g)	Box (pcs)	Carton (pcs)
APD -170	22	40	320
APDL -260	60	10	80

Material	Finish
ABS	Black (BLK), Brown (BRN), Ivory (IVY), Chrome (CR)-APD-170 type only

VENTILATOR (W/CABLE GROMMETS)

APD-KH

MISCELLANEOUS

VENTILATOR

- ABS ventilator.
- Removable grommet inserts for excellent cable management.

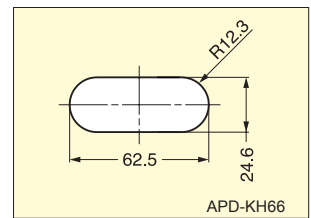
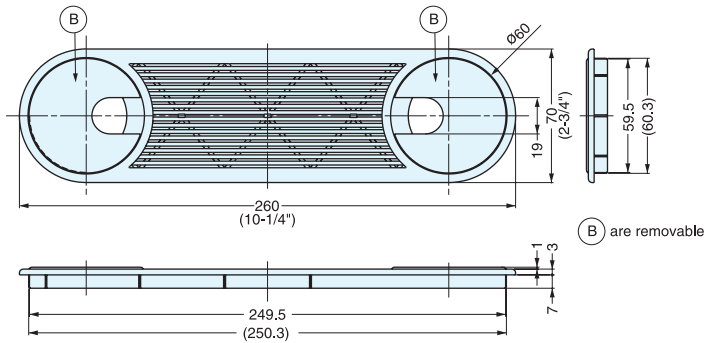
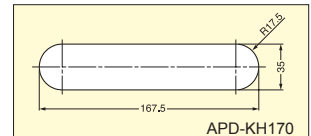
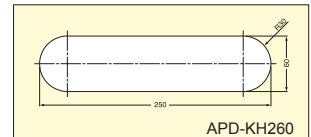
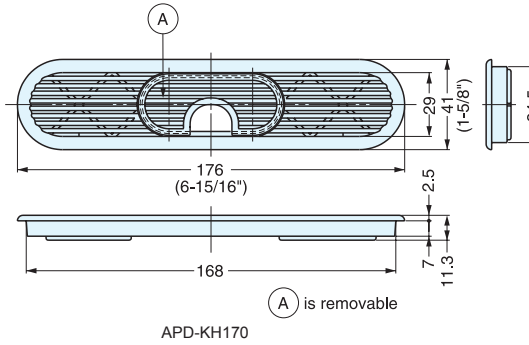
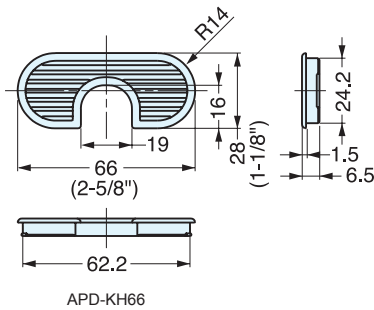
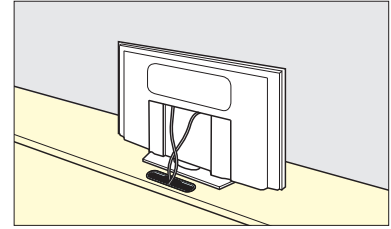

Cut Out Dimensions

Item No.	Material	Finish	Weight (g)	Box (pcs)	Carton (pcs)
APD-KH66-CR	ABS	Chrome	3.7	100	500
APD-KH66-IV		Ivory	3.0		
APD-KH66-BL		Black			
APD-KH66-BR		Brown			
APD-KH66-WT		White			
APD-KH170-CR		Chrome	24.0	40	320
APD-KH170-IV		Ivory	20.0		
APD-KH170-BL		Black			
APD-KH170-BR		Brown			
APD-KH170-WT		White	55.0	10	80
APD-KH260-IV		Ivory			
APD-KH260-BL		Black			
APD-KH260-BR		Brown			

VENTILATOR

APM



APM-5056/BRN

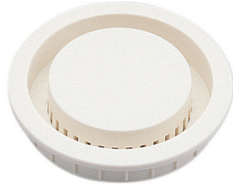

APM-5056/WHT

• Slits for ventilation cannot be seen from outside.

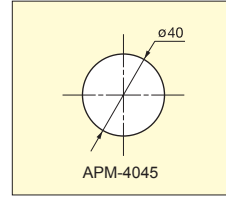
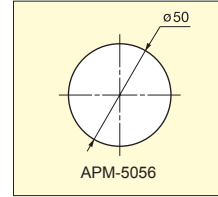

Bore Dimensions

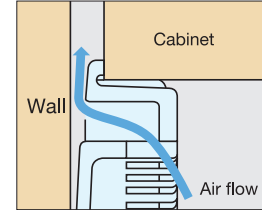
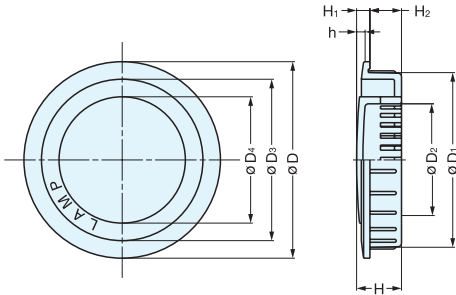

Allows air flow even if the surface of the ventilator is directly on the wall.

Material	Finish
ABS	White (WHT), Brown (BRN)

Please specify the finish when ordering.

Item No.	D	D ₁	D ₂	D ₃	D ₄	H	H ₁	H ₂	h	Bore Dimension	Weight (g)	Box (pcs)	Carton (pcs)
APM-4045	45 (1-25/32")	39.8 (1-9/16")	24.6	36.2	28.2	10.3	3.3	7	1.6	40	5	150	900
APM-5056	56 (2-13/64")	49.8 (1-31/32")	32.0	46.0	36.0	12.8	3.8	9	1.8	50	9	100	600

VENTILATOR

APB



APB-5056/WHT



APB-4045/WHT



APB-4090/WHT

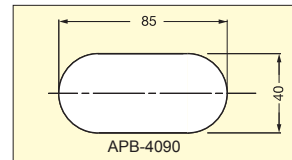
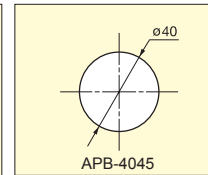
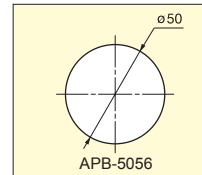

Bore Dimensions

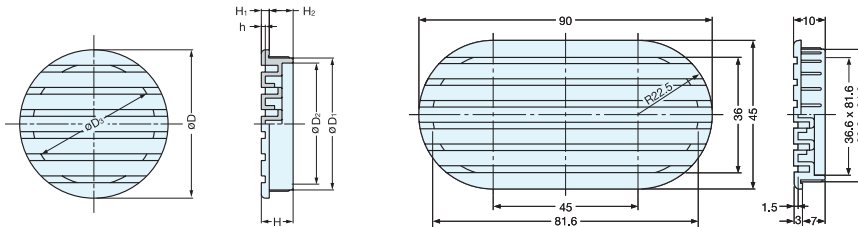

APB-4045, APB-5056

APB-4090

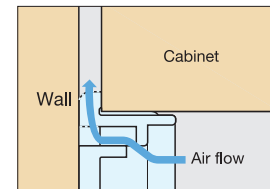

Allows air flow even if the surface of the ventilator is directly on the wall.

Material	Finish
ABS	White (WHT)

Item No.	D	D ₁	D ₂	D ₃	H	H ₁	H ₂	h	Bore Dimension	Weight (g)	Box (pcs)	Carton (pcs)
APB-4045	45 (1-25/32")	39.8 (1-9/16")	36.6	36.6	10	3	7	1.5	40	7	150	900
APB-5056	56 (2-13/64")	49.8 (1-31/32")	46.0	46.0	12		9		50	11	100	600
APB-4090	-	-	-	-	10		7		40 x 85	16	80	480

CABLE GROMMET



S445, S51, S60, S76, S89

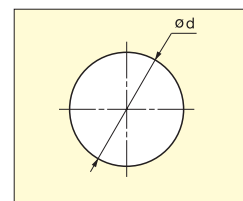
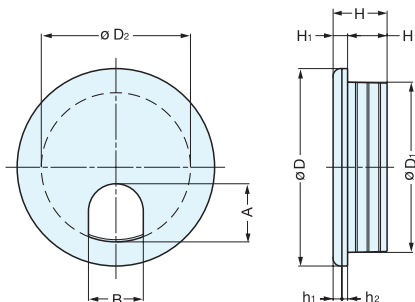

Bore Dimensions

Please specify the finish when ordering.

Material	Finish
ABS	White (WHT), Black (BLK)

Item No.	D	D ₁	D ₂	H	H ₁	H ₂	h ₁	h ₂	A	B	d	Weight (g)	Box (pcs)	Carton (pcs)
S445	45.0 (1-25/32")	38.8 (1-17/32")	34.0	19.7	3.3	16.4	2.0	1.3	16.7	12.5	38.5	8.7	100	1200
S51	51.0 (2")	44.5 (1-3/4")	39.7	19.9	3.6	16.3		1.6	19.0	15.5	44.2	11.1		800
S60	60.5 (2-3/8")	48.8 (1-59/64")	44.0	19.8		16.2			20.8	19.0	48.5	13.7		600
S76	76.5 (3-1/64")	64.4 (2-17/32")	59.0	20.3	4.2	16.1	2.6	1.5	21.5	21.5	64.2	21.8	50	350
S89	89.4 (3-33/64")	76.5 (3-1/64")	71.4	20.6	4.1	16.5			25.0	22.0	76.5	30.3		250

CABLE GROMMET



S165-76

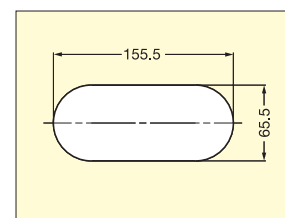
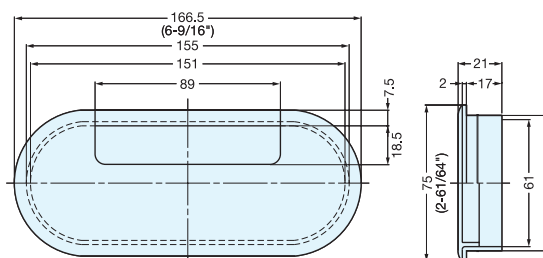

Bore Dimensions

Please specify the finish when ordering.

Item No.	Weight (g)	Box (pcs)	Carton (pcs)	Material	Finish
S165-76	47.7	150	1500	ABS	White (WHT), Black (BLK)

CABLE GROMMET



V60, V80



V60/WHT



V60/BLK

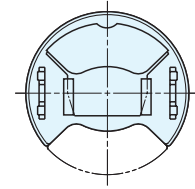
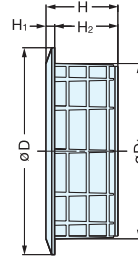
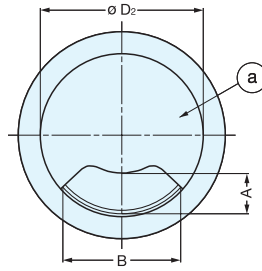

Backside of Cap (a)
(When lid open)

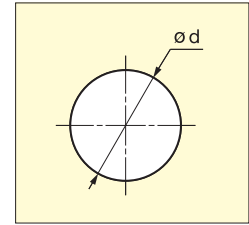

Bore Dimensions

Material	Finish
Plastic	White (WHT), Black (BLK)

Please specify the finish when ordering.

Item No.	D	D ₁	D ₂	H	H ₁	H ₂	A	B	d	Weight (g)	Box (pcs)	Carton (pcs)
V60	72 (2-27/32")	61.0 (2-13/32")	56.7	25	3	22	14	41	60.5	26.7	90	900
V80	92 (3-5/8")	80.5 (3-11/64")	77.0					50	80.0	37.9	88	880

CABLE GROMMET



V2000

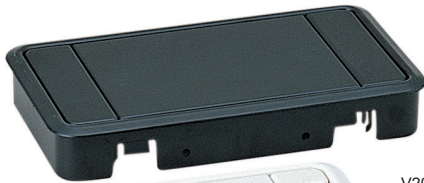

V2000/BLK

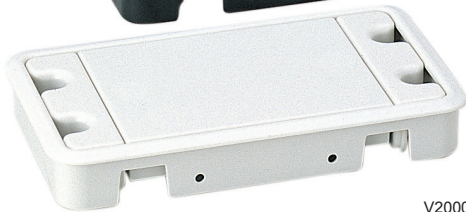

V2000/WHT

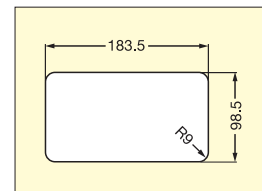
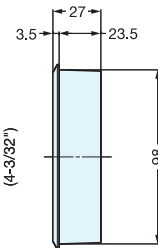
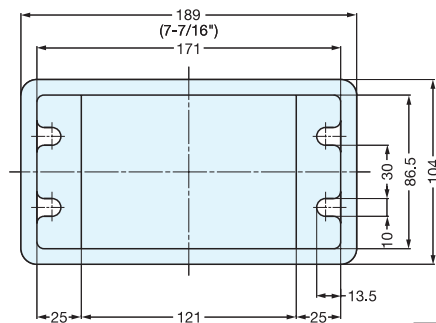
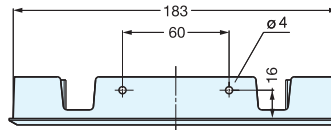

Bore Dimensions

Please specify the finish when ordering.

Item No.	Weight (g)	Box (pcs)	Carton (pcs)	Material	Finish
V2000	102	33	330	Plastic	White (WHT), Black (BLK)

CABLE GROMMET

LSU, LS

• Double-sided grommets.



LS60WHT

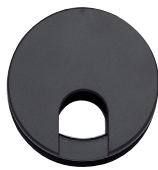

LS60BLK

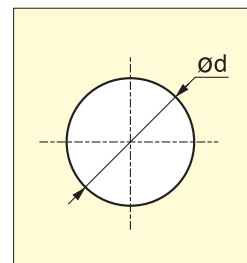
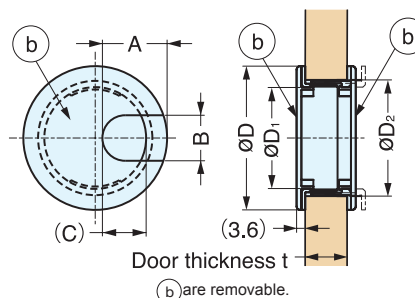

Bore Dimensions

Item No.	Finish	Material	D	D ₁	D ₂	A	B	C	t	d	Weight (g)	Box (pcs)	Carton (pcs)
LSU60WT	White	ABS	60 (2-3/8")	42.5 (1-43/64")	48.5	27	19	18.0	12~18 (1/2"~3/4")	48.5	19	20	160
LSU60BL	Black												
LS60WT	White								18~24 (3/4"~1")				
LS60BL	Black												
LS76WT	White		76 (3")	58.2 (2-19/64")	64.2	34	22	25.1	25~40 (1"~1-9/16")	64.2	25	12	96
LS76BL	Black												

CABLE GROMMET

CHC

• Choose from 1/2" (12 mm) or 19/32" (15 mm) grommets, perfect for phone, fax, or LAN data cables.

Weight: CHC-18 8.3 g
CHC-22 14.5 g



CHC-22/GB
(Antique Brass)



CHC-18/NI
(Nickel)



CHC-18/GA
(Gold)

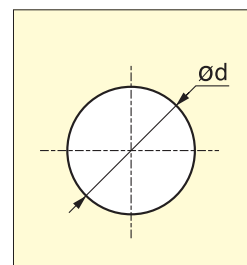
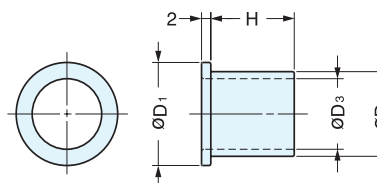

Bore Dimensions

Item No.	Material	Finish	H	D ₁	D ₂	D ₃	d	Box (pcs)
CHC-18/NI	Brass	Satin Nickel	16 (5/8")	18 (11/16")	14 (9/16")	12 (1/2")	14.5 (9/16")	120
CHC-18/GA		Gold						
CHC-18/GB		Antique Brass						
CHC-22/NI		Satin Nickel						
CHC-22/GA		Gold	18 (11/16")	22 (7/8")	18 (11/16")	15 (19/32")	18.5 (11/16")	60
CHC-22/GB		Antique Brass						

CABLE GROMMET

LN72D



LN72D/WT



LN72D/BL



Cover

Grommet

- Double-sided adjustable grommet
- For panel thickness 1-3/16" to 1-9/16" (30 to 40 mm); also for 11/16" to 1-9/16" (18 to 30 mm) by snapping off edge.
- Cover can be removed to increase the grommet opening.

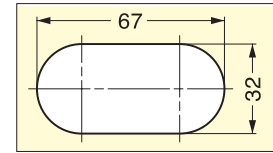
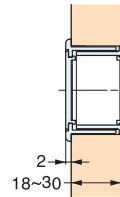
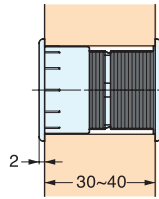
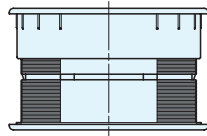
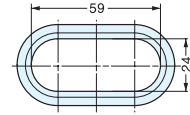
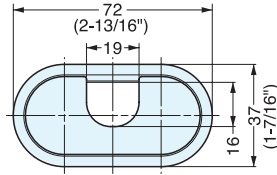

Bore Dimensions

Item No.	Color	Material	Weight (g)	Box (pcs)	Carton (pcs)
LN72D/WT	White	ABS	19	40	320
LN72D/BL	Black				

CABLE GROMMET

LN72S



LN72S/WT



LN72S/BL

- Cover can be removed to increase the grommet opening.

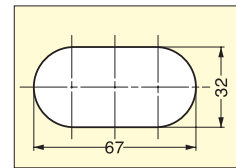
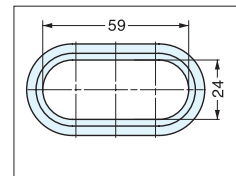
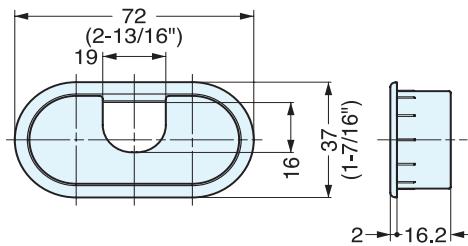

Bore Dimensions

Item No.	Color	Material	Weight (g)	Box (pcs)	Carton (pcs)
LN72S/WT	White	ABS	8	40	320
LN72S/BL	Black				

Zwei L Towel Bar

STAINLESS
316
STEEL

ZL-3201

MISCELLANEOUS

Zwei L TOWEL BARS



• Supplied with stainless steel wood screw (4.1 x 32), anchor plug and 3 mm allen key.

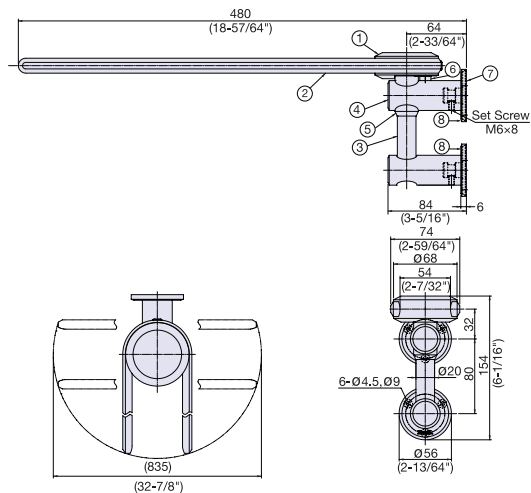

Item No.	Weight (g)	Box (pcs)	
ZL-3201	-	1	
No.	Part Name	Material	Finish
①	Bracket	316 Stainless Steel	Zwei L
②	Arm		Mirror
③	Pin		Zwei L
④	Post		
⑤	Bushing	Polyacetal	Black
⑥	Swivel Stopper		
⑦	Base Plate	316 Stainless Steel	Plain
⑧	Cover		Zwei L

Zwei L Towel Bar

STAINLESS
316
STEEL

ZL-3202



• Supplied with stainless steel wood screws (4.1 x 25) and concrete anchor (for wood screw 4.1, Ø6 mm hole).

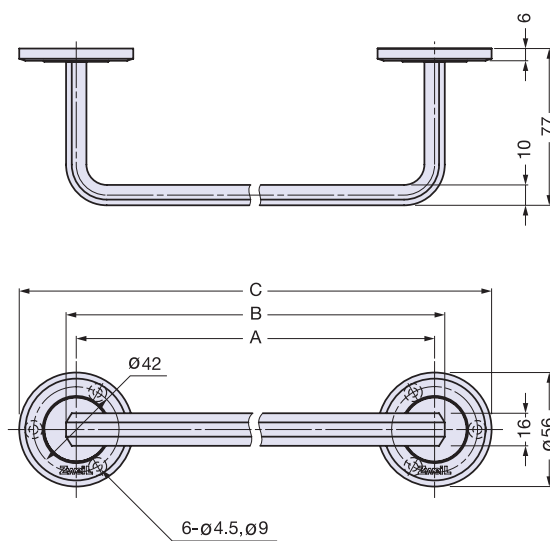

Item No.	Material	Finish/Color	A	B	C
ZL-3202-480	316 Stainless Steel	Zwei L	480	490	536 (21-7/64")
ZL-3202-640			640	650	696 (27-13/32")

TOWEL BAR



KB-T

• Supplied with 4 x 20 stainless steel wood screws.

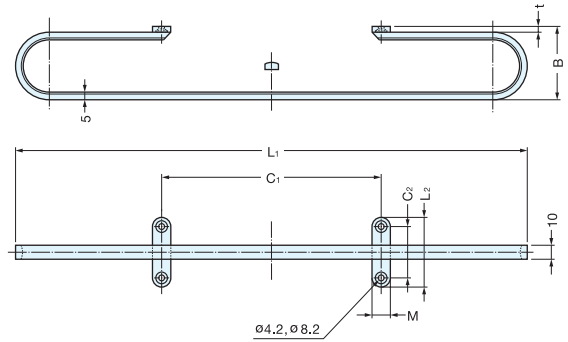

Material	Finish
303 Stainless Steel	Mirror

Item No.	B	C ₁	C ₂	L ₁	L ₂	M	t	Weight (g)	Box (pcs)	Carton (pcs)
KB-T-350	50	150	35	350 (13-25/32")	48	13	4	240	1	10
KB-T-450		250		450 (17-23/32")				275		

TOWEL BAR



DSR-01/18

• Supplied with screws, brackets, plastic expansion anchors and allen key.

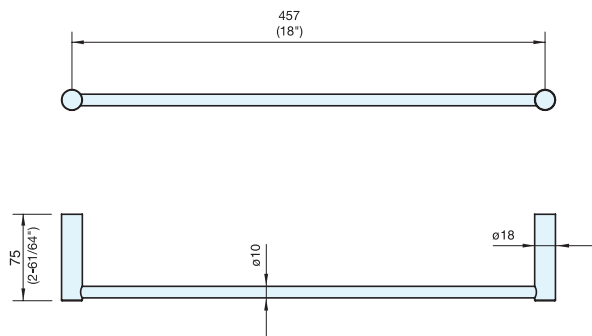

Item No.	Weight (g)	Box (pcs)	Carton (pcs)	Material	Finish
DSR-01/18	580	1	10	303/304 Stainless Steel	Satin

TOWEL BAR



DST-06

- Supplied with screw, bracket, plastic expansion anchor and allen key.

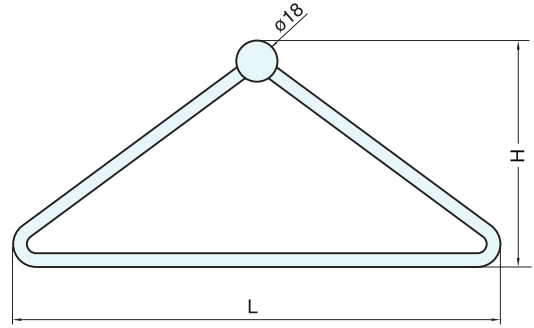
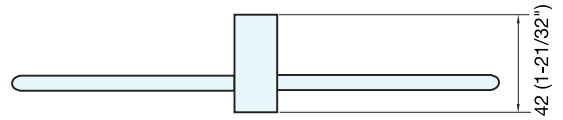
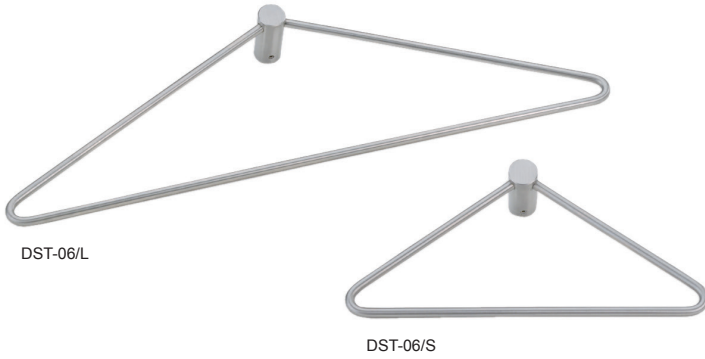

Item No.	L	H	Weight (g)	Box (pcs)	Carton (pcs)
DST-06/S	213 (8-25/64")	108 (4-1/4")	173	1	10
DST-06/L	390 (15- 3/8")	125 (4-15/16")	241		

Material	Finish
303/304 Stainless Steel	Satin

TOWEL BAR



DSR-02

- Supplied with screws, brackets, plastic expansion anchors and allen key.



DSR-02/50

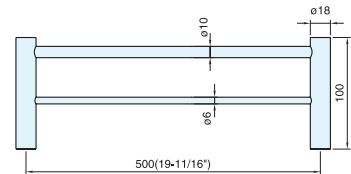

DSR-02/98

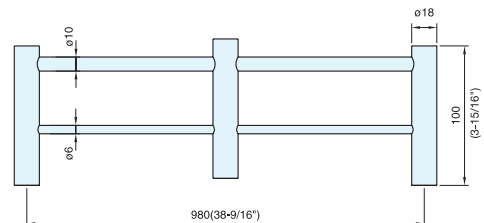

Item No.	Weight (g)	Box (pcs)	Carton (pcs)
DSR-02/50	777	1	10
DSR-02/98	1352		

Material	Finish
303/304 Stainless Steel	Satin

TOWEL RACK



DSR-08

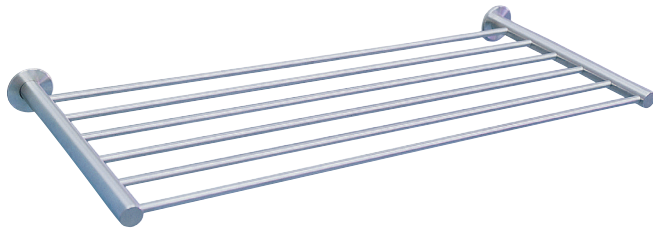

- Supplied with screws, brackets, plastic expansion anchors and allen key.

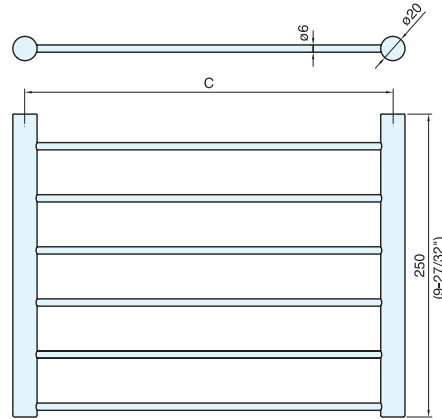

Item No.	C	Weight (g)	Box (pcs)	Carton (pcs)
DSR-08/45	450 (17-3/4")	1423	1	10
DSR-08/60	600 (23-5/8")	1778		

Material	Finish
303/304 Stainless Steel	Satin

TOWEL RACK



DSD-80

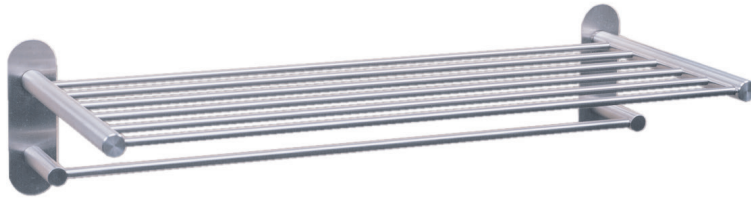

- Supplied with screws, brackets, plastic expansion anchors and allen key.

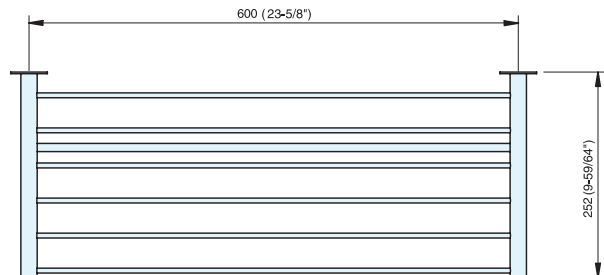

Item No.	Weight (g)	Box (pcs)	Carton (pcs)
DSD-80	2700	1	10

Material	Finish
303/304 Stainless Steel	Satin

TOILET PAPER HOLDER



DSB-01

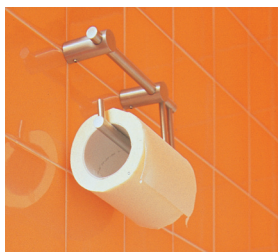
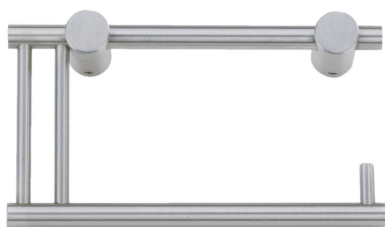

- Supplied with screws, brackets, plastic expansion anchors and allen key.

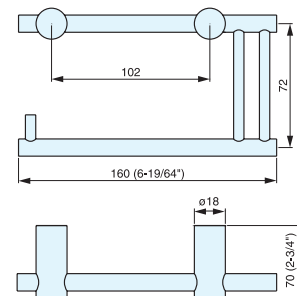

Item No.	Weight (g)	Box (pcs)	Carton (pcs)
DSB-01	456	1	10

Material	Finish
303/304 Stainless Steel	Satin

TOILET PAPER HOLDER



DSB-03



- Toilet paper holder for side-wall mount.
- Supplied with screw and plastic expansion anchor.

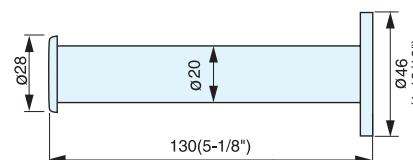

Item No.	Weight (g)	Box (pcs)	Carton (pcs)
DSB-03	201	5	50

Material	Finish
303/304 Stainless Steel	Satin

PAPER TOWEL HOLDER



DSB-04



- Paper towel holder, also can be used as towel bar.
- Supplied with screws, brackets, plastic expansion anchors and allen key.

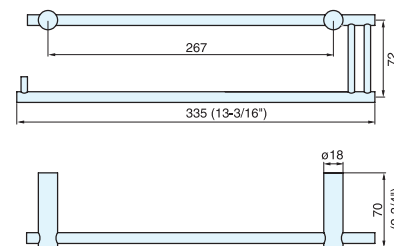

Item No.	Weight (g)	Box (pcs)	Carton (pcs)
DSB-04	669	1	10

Material	Finish
303/304 Stainless Steel	Satin

TOILET BRUSH/HOLDER



DSB-09

- Removable plastic basket for easy cleaning.
- Supplied with screws, brackets, plastic expansion anchors and allen key.

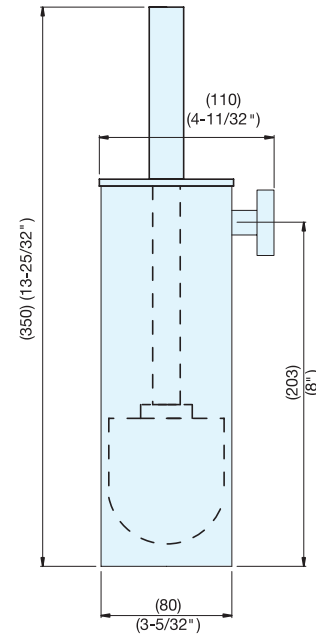

Item No.	Weight (g)	Box (pcs)	Carton (pcs)
DSB-09	748	1	10

Material	Finish
303/304 Stainless Steel	Satin

TOILET PAPER HOLDER



DSB-07

- Toilet paper stand ideal to keep stock organized.

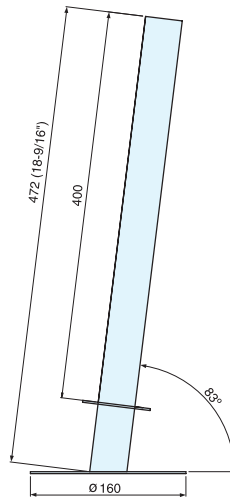

Item No.	Weight (g)	Box (pcs)	Carton (pcs)
DSB-07	1009	1	10

Material	Finish
304 Stainless Steel	Satin

MULTI-PURPOSE LID W/DAMPER



AZ-GD231-HL



- Installed from the inside of the waste box for clean appearance.
- With damper to keep the lid from slamming shut.
- Integrated with anti-pinching plates.
- Corrosion resistant.
- Guide sold separately (AZ-SLP)



[Application Example]

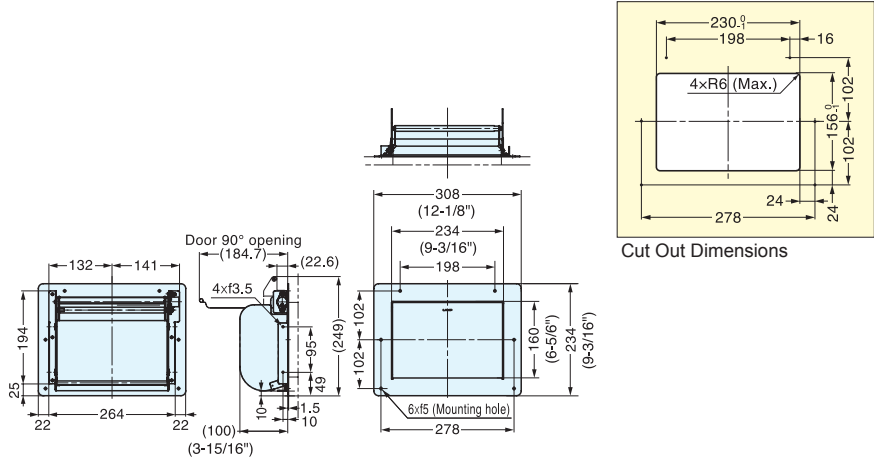

Cut Out Dimensions

Item No.	L	H	D	Weight (g)	Box (pcs)	Carton (pcs)	Material	Finish
AZ-GD231-HL	308 (12-1/8")	234 (9-3/16")	100 (3-15/16")	1486	1	10	304 Stainless Steel	Satin

MULTI-PURPOSE LID W/DAMPER



AZ-GD232-HL



- Able to install the lid up to 45°.
- Inclined mount.
- Easy to adjust angle by changing the weight position.
- Integrated anti-pinching plates.
- Corrosion resistant.
- Guide sold separately.

[Installation]

[How to Adjust Angle]

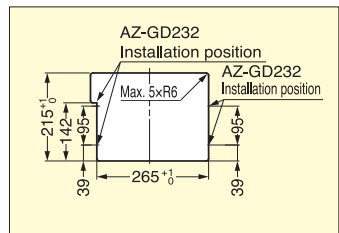
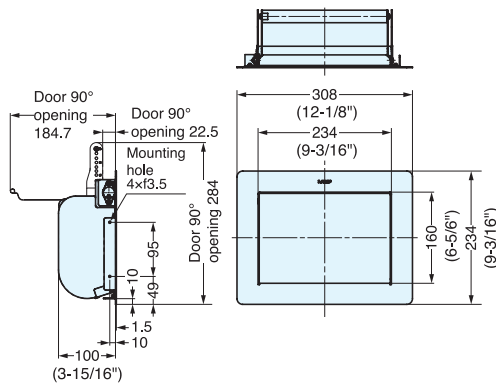
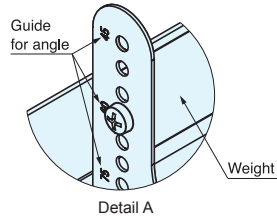
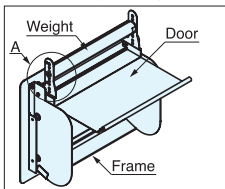
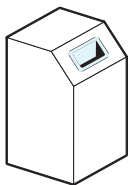

Cut Out Dimensions

Item No.	L	H	D	Weight (g)	Box (pcs)	Carton (pcs)	Material	Finish
AZ-GD232-HL	308 (12-1/8")	234 (9-3/16")	100 (3-15/16")	2200	1	10	304 Stainless Steel	Satin

MULTI-PURPOSE LID W/DAMPER



AZ-GD

MISCELLANEOUS

MULTI-PURPOSE LID W/DAMPER



AZ-GD180-HL



AZ-GD230-HL



AZ-GD310-HL



AZ-GD400-HL
(Slim Frame Type)

- Built in damper to keep the lid from slamming shut.
- Integrated anti-pinching plates.
- Vertical use only.
- Corrosion resistant.
- Guide sold separately.

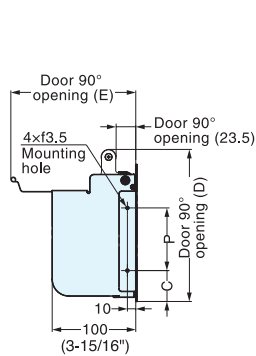
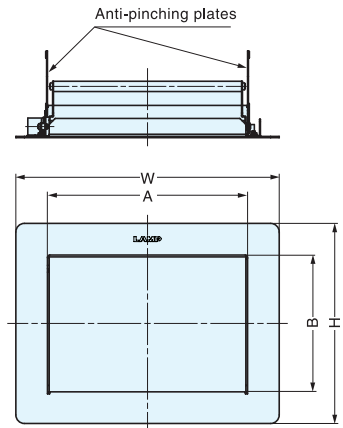

AZ-GD180-HL

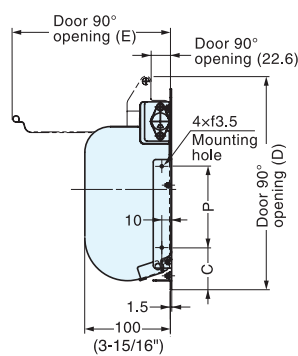

AZ-GD230-HL
AZ-GD310-HL

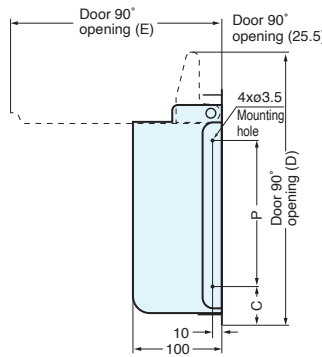

AZ-GD400-HL

Cut Out Dimensions

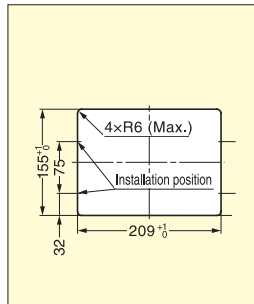

AZ-GD180-HL

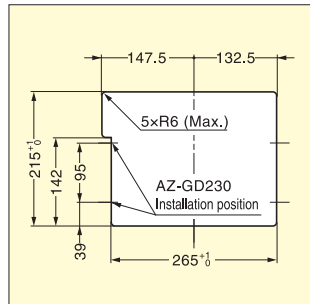

AZ-GD230-HL

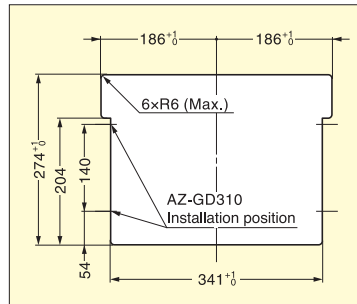

AZ-GD310-HL

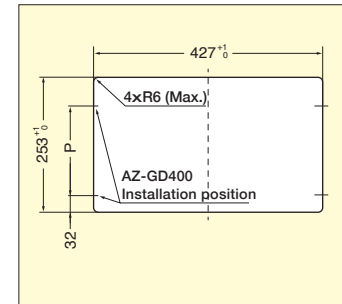

AZ-GD400-HL

Material	Finish
304 Stainless Steel	Satin

Item No.	A	B	W	H	C	D	E	P	Weight (g)	Box (pcs)	Carton (pcs)
AZ-GD180-HL	182 (7-11/64")	128 (5-3/64")	218 (8-37/64")	164 (6-29/64")	37	182	149.5	75	1042	1	10
AZ-GD230-HL	234 (9-7/32")	160 (6-19/64")	308 (12-1/8")	234 (9-7/32")	49	249	184.7	95	1486		
AZ-GD310-HL	310 (12-13/64")	220 (8-21/32")	384 (15-1/8")	294 (11-37/64")	64	310	244.7	140	2236		
AZ-GD400-HL	400 (15-3/4")	220 (8-21/32")	450 (17 23/32")	270 (10-5/8")	44	312	240.0	167	2236		

GUIDE FOR MULTI-PURPOSE LID



AZ-SLP



- Guide for garbage into waste basket.
- Use with AZ-GD, AZ-GD231-HL, AZ-GD232-HL and AZ-HD.

[Application Example]

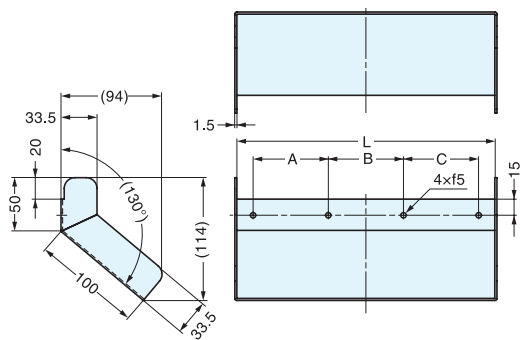

[Installation]

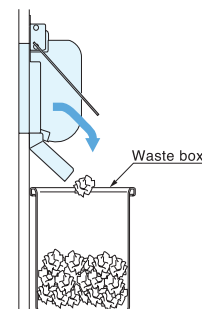

Item No.	A	B	C	L	Weight (g)	Box (pcs)	Carton (pcs)	Material	Finish
AZ-SLP230	70	70	70	241	450	20	-	304 Stainless Steel	Satin
AZ-SLP310	80	80	80	317	570				

MULTI-PURPOSE LID (W/HANDLE)



AZ-HD230/HL, 310/HL



- Easy to open with the handle.
- No need to put hands inside enclosure.
- 304 Stainless Steel lid, frame, and handle.

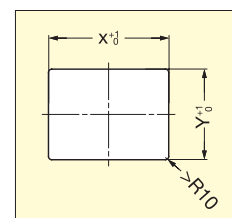
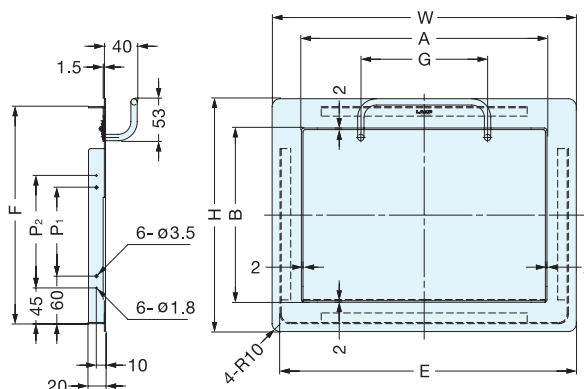

Cut Out Dimensions

Item No.	A	B	W	H	E	F	G	P ₁	P ₂	X	Y	Weight (g)	Box (pcs)	Carton (pcs)
AZ-HD230/HL	234 (9-7/32")	160 (6-19/64")	308 (12-1/8")	234 (9-7/32")	288	214	120 (4-23/32")	60	90	289	215	1800	1	10
AZ-HD310/HL	310 (12-13/64")	220 (8-21/32")	384 (15-1/8")	294 (11-37/64")	364	274	160 (6-19/64")	112	142	365	275	2200		

Material	Finish
304 Stainless Steel	Satin

MULTI-PURPOSE LID (W/DAMPER)



AD-KH

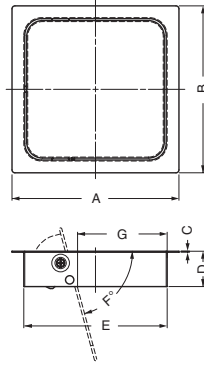

- Features damper to keep lid from slamming shut.
- Made of stainless steel for corrosion resistance.
- Wide opening.
- Balance weight restores lid to horizontal position.
- Operating temperature: 32°F~104°F.

6-11/16" (170 mm)



AD-KH015-HL

8-11/16" (220 mm)



AD-KH020-HL

11-13/16" (300 mm)

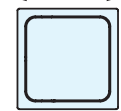

AD-KH028-HL

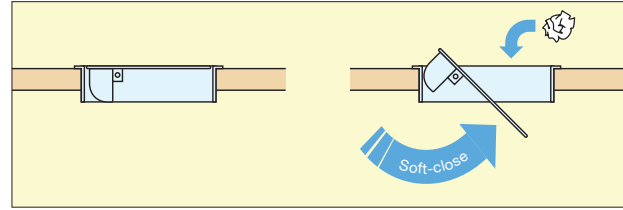
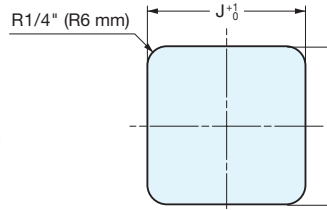

Item No.	Material	Finish	A	B	C	D	E	F	G	H	J	Weight (g)
AD-KH015-HL	304 Stainless Steel	Satin	6-11/16" (170 mm)	6-11/16" (170 mm)	1/16" (1.2 mm)	1-7/16" (36 mm)	5-3/4" (146 mm)	80°	3-11/16" (93 mm)	5-13/16" (147 mm)	5-13/16" (147 mm)	970
AD-KH020-HL			8-11/16" (220 mm)	8-11/16" (220 mm)	1/16" (1.2 mm)	2" (50 mm)	7-3/4" (196 mm)	77°	5" (127 mm)	7-3/4" (197 mm)	7-3/4" (197 mm)	1400
AD-KH028-HL			11-13/16" (300 mm)	11-13/16" (300 mm)	1/16" (1.2 mm)	2-13/16" (72 mm)	10-7/8" (276 mm)	80°	7-1/2" (191 mm)	10-15/16" (277 mm)	10-15/16" (277 mm)	2700

MULTI-PURPOSE GROMMET



AN-KH

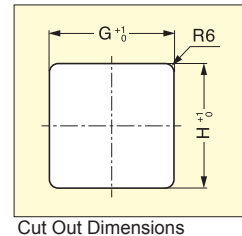
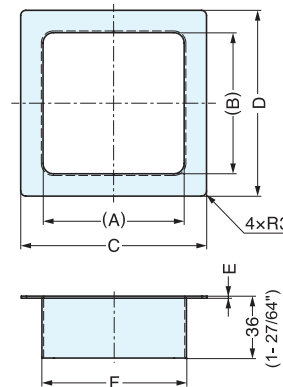

Cut Out Dimensions

- Corrosion resistant.
- Ideal for small dustbin applications.

Material	Finish
304 Stainless Steel	Satin

Item No.	Old Item No.	A	B	C	D	E	F	G	H	Weight (g)	Box (pcs)	Carton (pcs)
AN-KH005-HL	-	56 (2-13/64")	56 (2-13/64")	82 (3-15/64")	82 (3-15/64")	1.2	58	59	59	87	1	150
AN-KH008-HL	AN-KH001	82 (3-15/64")	82 (3-15/64")	108 (4-1/4")	108 (4-1/4")		84	85	85	126		10
AN-KH015-HL	AN-KH017	144 (5-43/64")	144 (5-43/64")	170 (6-11/16")	170 (6-11/16")		146	147	147	217		

MULTI-PURPOSE LID (SOFT CLOSE)



AD-GD

- Soft and slow closing movement with a built-in damper mechanism.
- Horizontal use only.

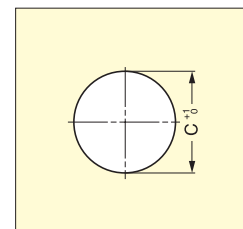
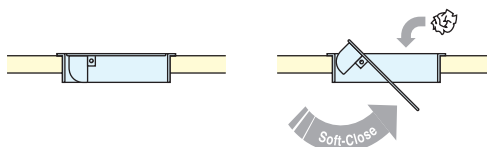

Cut Out Dimensions

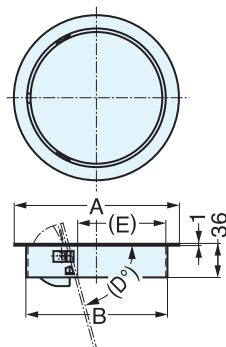

Material	Finish
304 Stainless Steel	Satin
303 Stainless Steel	
Polyacetal	
Steel	
CRC	
NBR (Rubber)	

Item No.	Old Item No.	A	B	C	D	E	Weight (g)	Box (pcs)	Carton (pcs)
AD-GD011-HL	AD-DH011-HL	136 (5-23/64")	106 (4-11/64")	107 (4-7/32")	87 (3-27/64")	62 (2-7/16")	460	1	10
AD-GD015-HL	AD-DH017-HL	170 (6-11/16")	146 (5-3/4")	147 (5-25/32")	75 (2-61/64")	90 (3-35/64")	1000		

MULTI-PURPOSE LID



AD-DH015-HL

- Self-leveling lid.
- Horizontal use only.

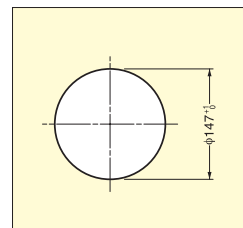
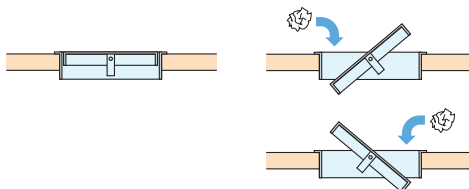

Cut Out Dimensions

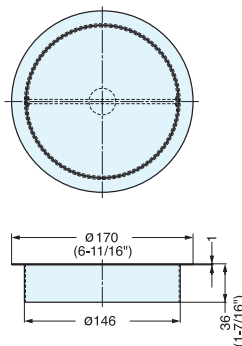

Item No.	Weight (g)	Box (pcs)	Carton (pcs)	Material	Finish
AD-DH015-HL	554	1	10	304 Stainless Steel	Satin

DRAIN SPOUT



AN-DH020

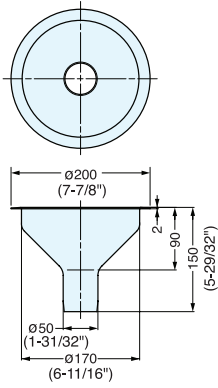

- Wide 6-11/16" diameter drain spout for use in food service environments.
- Lip outer diameter 7-7/8".
- Stainless steel construction for easy cleaning.
- 2" diameter tubing can be attached to the spout.

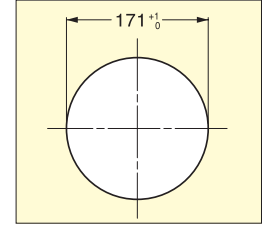
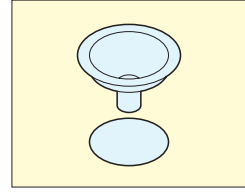

Cut Out Dimensions

Item No.	Weight (g)	Box (pcs)	Carton (pcs)	Material	Finish
AN-DH020	490	1	10	304 Stainless Steel	Polished Mirror/Satin

MULTI-PURPOSE LID (DOUBLE DOOR)



AZ-DD310/HL

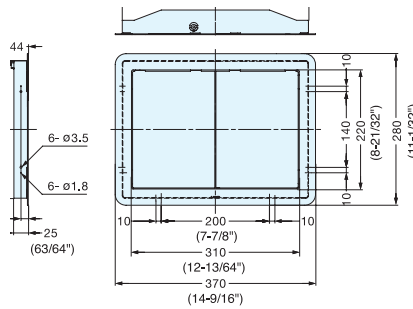

- Synchronized doors allow for easy opening.
- 304 Stainless Steel lid and frame.

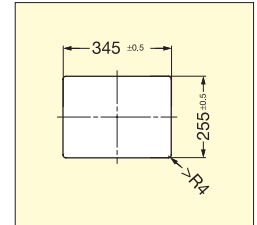

Cut Out Dimensions

Item No.	Weight (kg)	Box (pcs)	Carton (pcs)	Material	Finish
AZ-DD310/HL	2.2	1	10	304 Stainless Steel	Satin

MULTI-PURPOSE LID (SQUARE BEZEL)



AZ-ND

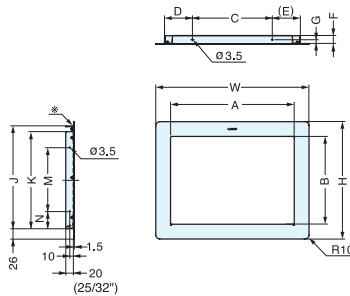
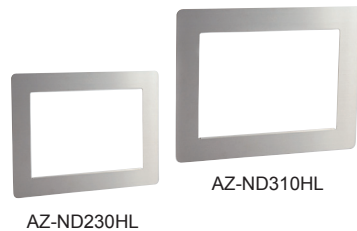

- Corrosion resistant.
- 304 Stainless Steel

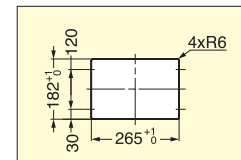

AZ-ND230HL Cut Out Dimensions

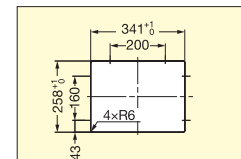

AZ-ND310HL Cut Out Dimensions

Item No.	Material	Finish	A	B	W	H				
AZ-ND230	Stainless Steel (SUS304)	Satin	234 (9-7/32")	160 (6-19/64")	308 (12-1/8")	234 (9-7/32")				
AZ-ND310HL			310 (12-13/64")	220 (8-21/32")	384 (15-1/8")	394 (15-33/64")				
Item No.	C	D	E	F	G	J	K	M	N	Weight (kg)
AZ-ND230HL	-	-	-	-	-	-	170	120	30	0.72
AZ-ND310HL	200	70	70	20	10	257	243	160	43	1.05

MULTI-PURPOSE GROMMET



AN-DH, AN-LH

- Corrosion resistant.
- Wide range of sizes and finishes.

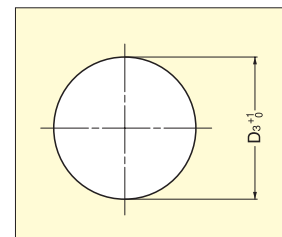
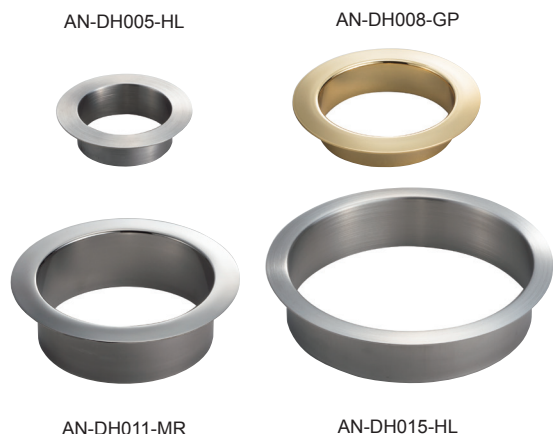

Cut Out Dimensions



AN-DH:Deep Type

AN-LH:Shallow Type

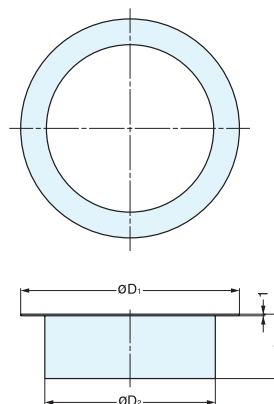
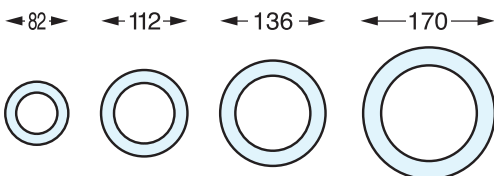

Item No.	Old Item No.	A	D ₁	D ₂	D ₃	Material	Finish	Weight (g)
AN-DH005-GP	-	36	82 (3-15/64")	58 (2-9/32")	59 (2-21/64")	Stainless Steel (SUS 304)	Gold	66
AN-DH005-MR	-						Mirror	
AN-DH005-HL	-						Satin	
AN-DH008-GP	AN-DH001-GP	36	112 (4-13/32")	82 (3-15/64")	83 (3-17/64")		Gold	107
AN-DH008-MR	AN-DH001-MR						Mirror	
AN-DH008-HL	AN-DH001-HL						Satin	
AN-DH011-GP	-	40	136 (5-23/64")	106 (4-11/64")	107 (4-7/32")		Gold	137
AN-DH011-MR	-						Mirror	
AN-DH011-HL	-						Satin	
AN-DH015-GP	-	36	170 (6-11/16")	146 (5-3/4")	147 (5-25/32")	Gold	182	
AN-DH015-MR	-					Mirror		
AN-DH015-HL	-					Satin		

Item No.	Old Item No.	A	D ₁	D ₂	D ₃	Material	Finish	Weight (g)
AN-LH005-GP	-	22	82 (3-15/64")	58 (2-9/32")	59 (2-21/64")	Stainless Steel (SUS 304)	Gold	50
AN-LH005-MR	-						Mirror	
AN-LH005-HL	-						Satin	
AN-LH008-GP	AN-LH001-GP	22	112 (4-13/32")	82 (3-15/64")	83 (3-17/64")		Gold	77
AN-LH008-MR	AN-LH001-MR						Mirror	
AN-LH008-HL	AN-LH001-HL						Satin	
AN-LH011-GP	-	22	136 (5-23/64")	106 (4-11/64")	107 (4-7/32")		Gold	92
AN-LH011-MR	-						Mirror	
AN-LH011-HL	-						Satin	
AN-LH015-GP	-	22	170 (6-11/16")	146 (5-3/4")	147 (5-25/32")	Gold	122	
AN-LH015-MR	-					Mirror		
AN-LH015-HL	-					Satin		