

# ENCLOSURES



EXTRUSION CORNER CONNECTORS  
MULTI-PURPOSE LID  
CABLE GROMMET  
VENTILATORS

VENTILATORS

Picture	Item No.		Page
	SAM		451
	SAD		451
	ASM		451
	ASD		452
	AST		452
	AST-160, 210		452
	1-1122		453
	1-1212		453
	1-2211		453
	1-2222		454
	APB		454
	APM		454
	APK, APKL		455
	APD, APDL		455
	UTA-105		456
	APK-K		456
	APK-KH		457
	APD-KH		458

CABLE GROMMETS

Picture	Item No.	Page
	S445, S51, S60, S76, S89	459
	S165-76	459
	V60, V80	460
	V2000	460
	WSM-150	461
	WSD	462

MULTI-PURPOSE LIDS

Picture	Item No.		Page
	AZ-GD230/HL, AZ-SD310/HL		463
	AZ-HD230/HL, 310/HL		463
	AD-KH017-HL		464
	AN-KH		464
	AD-GD		465
	AD-DH015		465
	AZ-DD310/HL		466
	AZ-ND		466
	AN-DH, AN-LH		467

CORNER CONNECTORS

Picture	Item No.	Page
	PJ-100	468
	PJ-60A, PJ-80A	469

# VENTILATOR



# SAM

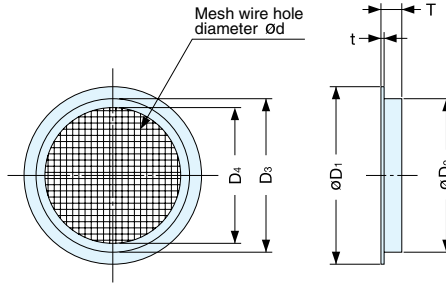

• 0.4mm diameter for mesh wire holes.

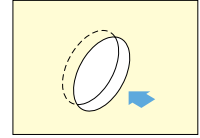

Material	Finish
304 Stainless Steel	Satin

Item No.	D <sub>1</sub>	D <sub>2</sub>	D <sub>3</sub>	D <sub>4</sub>	T	t	d	Weight (g)	Box (pcs)	Carton (pcs)
SAM-37	36 (1-27/64")	31.5 ( 1-1/4" )	30.0	25	5.2	0.3	0.4	4.5	70	1400
SAM-45	46 (1-13/16")	41.5 (1-41/64")	40.0	35				6.0	60	1200
SAM-60	60 (2-23/64")	53.5 (2-7/64")	52.0	46				6.5	50	1000
SAM-85	85 (3-11/32")	77.8 (3-1/16")	76.5	68				7.0	30	600
SAM-120	120 (4-23/32")	110.5 (4-23/64")	108.0	99	7.2	0.5	46.5	20	200	

# VENTILATOR



# SAD

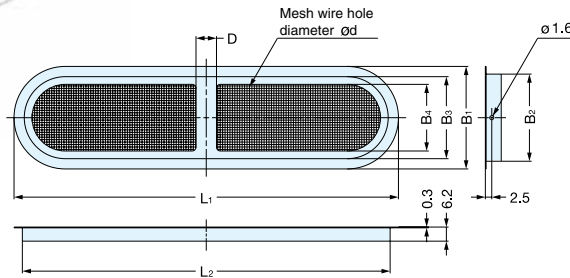

• 0.4mm diameter for mesh wire holes.

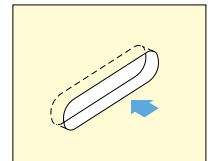

Material	Finish
304 Stainless Steel	Satin

Item No.	L <sub>1</sub>	B <sub>1</sub>	B <sub>3</sub>	B <sub>4</sub>	L <sub>2</sub>	B <sub>2</sub>	D	d	Weight (g)	Box (pcs)	Carton (pcs)
SAD-150	150.0 (5-29/32")	40 (1-37/64")	32	26	143.5	34	8	0.4	18.5	30	600
SAD-200	200.5 (7-57/64")	50 (1-31/32")	42	35	194.0	44	10		30.0		300

# VENTILATOR



# ASM

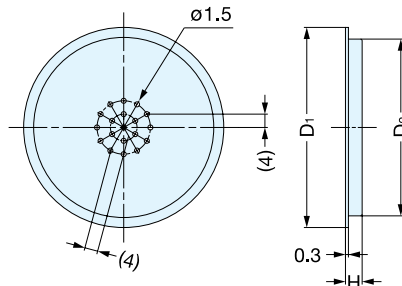

• 1.5 mm (1/16") diameter holes.

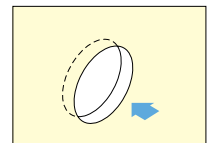

Material	Finish
304 Stainless Steel	Satin

Item No.	D <sub>1</sub>	D <sub>2</sub>	H	Holes	Weight (g)	Box (pcs)	Carton (pcs)
ASM-37	36 (1-27/64")	31 ( 1-7/32" )	4.5	37	3.0	100	3600
ASM-45	46 (1-13/16")	41 (1-39/64")		59	5.0		
ASM-60	60 (2-23/64")	53 (2-3/32")	5.0	127	8.0		
ASM-85	85 (3-11/32")	77 (3-1/32")		271	13.5	50	1000

## VENTILATOR



**ASD**

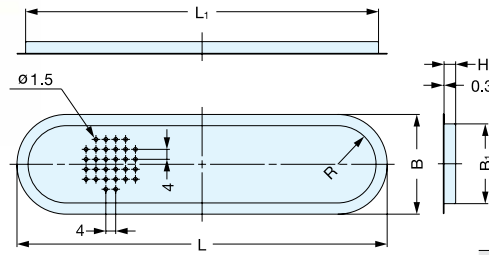

• 1.5 mm (1/16") diameter holes.

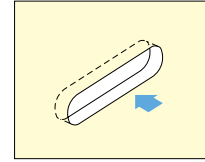

Material	Finish
304 Stainless Steel	Satin

Item No.	L	L <sub>1</sub>	H	B	B <sub>1</sub>	R	Holes	Weight (g)	Box (pcs)	Carton (pcs)
ASD-150	150 (5-29/32")	143 ( 5-5/8" )	5	40 (1-37/64")	33.0	16	268	14.5	80	1920
ASD-200	200 ( 7-7/8" )	193 (7-19/32")		50 (1-31/32")	42.8	21	450	23.0	40	960

## VENTILATOR



**AST**

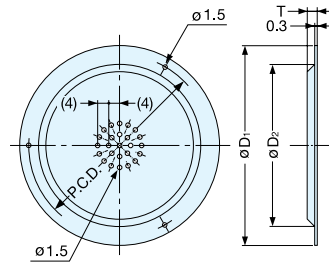

• 1.5 mm (1/16") diameter holes.

Material	Finish
304 Stainless Steel	Satin

Item No.	D <sub>1</sub>	D <sub>2</sub>	T	P.C.D.	Holes	Weight (g)	Box (pcs)	Carton (pcs)
AST-45	45 (1-25/32")	34 (1-11/32")	3	40	37	4	100	3600
AST-55	55 ( 2-5/32" )	44 (1-47/64")		50	59	5		
AST-70	70 ( 2-3/4" )	55 ( 2-5/32" )		64	127	9		
AST-100	100 (3-15/16")	81 ( 3-3/16" )	4	91	271	19	50	500

## VENTILATOR



**AST-160, 210**

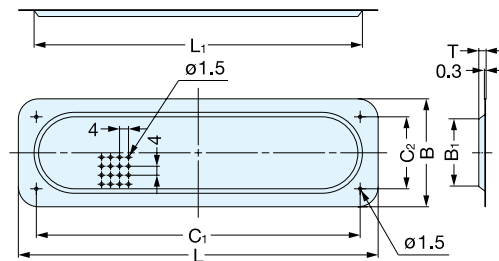

• 1.5 mm (1/16") diameter holes.

Material	Finish
304 Stainless Steel	Satin

Item No.	L	L <sub>1</sub>	B	B <sub>1</sub>	C <sub>1</sub>	C <sub>2</sub>	T	Holes	Weight (g)	Box (pcs)	Carton (pcs)
AST-160	160 (6-19/64")	146 ( 5-3/4" )	48 (1-57/64")	36	144	32	3	268	18	50	1000
AST-210	210 (8-17/64")	196 (7-23/32")	58 ( 2-9/32" )	46	194	42	4	450	28		200

# STAINLESS STEEL VENTILATOR



1-1122

• Ideal for harsh and corrosive environments.

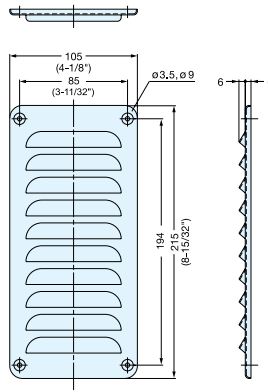

Item No.	Weight (g)	Box (pcs)	Carton (pcs)	Material	Finish
1-1122	165	10	100	316 Stainless Steel	Satin

# STAINLESS STEEL VENTILATOR



1-1212

• Ideal for harsh and corrosive environments.

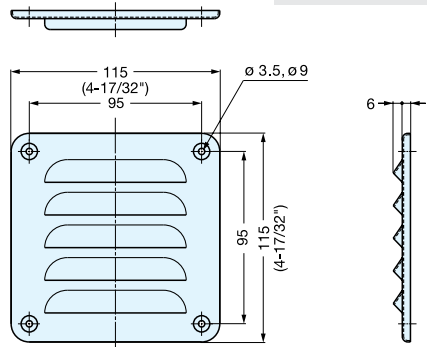

Item No.	Weight (g)	Box (pcs)	Carton (pcs)	Material	Finish
1-1212	165	10	100	316 Stainless Steel	Satin

# STAINLESS STEEL VENTILATOR



1-2211

• Ideal for harsh and corrosive environments.

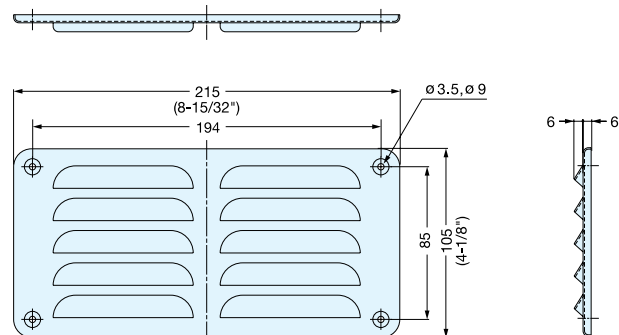

Item No.	Weight (g)	Box (pcs)	Carton (pcs)	Material	Finish
1-2211	165	10	100	316 Stainless Steel	Satin

ENCLOSURE COMPONENTS

STAINLESS STEEL VENTILATORS

# STAINLESS STEEL VENTILATOR



1-2222

• Ideal for harsh and corrosive environments.

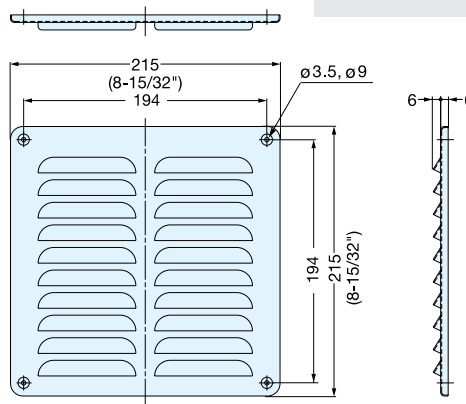

Item No.	Weight (g)	Box (pcs)	Carton (pcs)	Material	Finish
1-2222	295	10	100	316 Stainless Steel	Satin

## VENTILATOR

APB

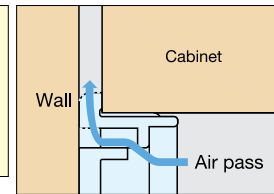
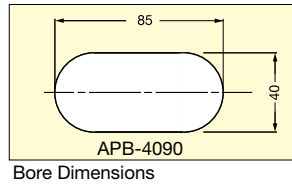
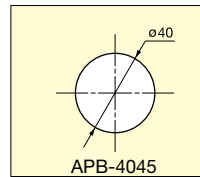
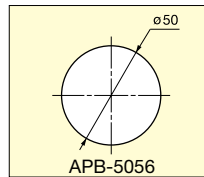
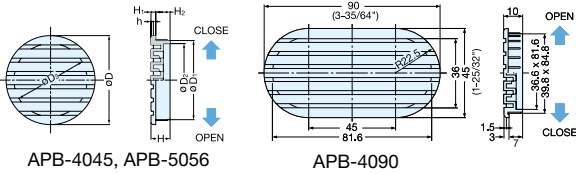

Allows air flow even if the surface of the ventilator is directly on the wall.

Material	Finish
ABS	White (WHT)

Item No.	D	D <sub>1</sub>	D <sub>2</sub>	D <sub>3</sub>	H	H <sub>1</sub>	H <sub>2</sub>	h	Bore Dimension	Weight (g)	Box (pcs)	Carton (pcs)
APB-4045	45 (1-25/32")	39.8 (1-9/16")	36.6	36.6	10	3	7	1.5	40	7	150	900
APB-5056	56 (2-13/64")	49.8 (1-31/32")	46.0	46.0	12		9		50	11	100	600
APB-4090	45 (1-25/32")	39.8 (1-9/16")	36.6	22.5	10		7		40x85	16	80	480

## VENTILATOR

APM

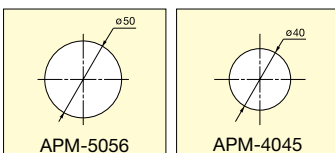

Bore Dimensions

Please specify the finish when ordering.

• Slits for ventilation cannot be seen from the outside.

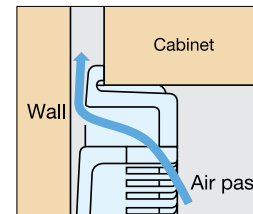
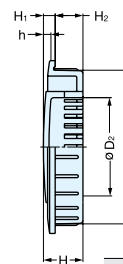
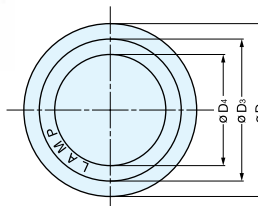

Allows air flow even if the surface of the ventilator is directly on the wall.

Material	Finish
ABS	White (WHT)/Brown (BRN)

Item No.	D	D <sub>1</sub>	D <sub>2</sub>	D <sub>3</sub>	D <sub>4</sub>	H	H <sub>1</sub>	H <sub>2</sub>	h	Bore Dimension	Weight (g)	Box (pcs)	Carton (pcs)
APM-4045	45 (1-25/32")	39.8 (1-9/16")	24.6	36.2	28.2	10.3	3.3	7	1.6	40	5	150	900
APM-5056	56 (2-13/64")	49.8 (1-31/32")	32.0	46.0	36.0	12.8	3.8	9	1.8	50	9	100	600

# VENTILATOR



## APK, APKL



• ABS ventilator.

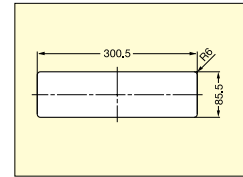
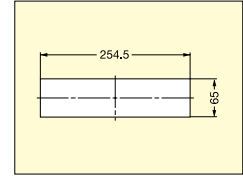
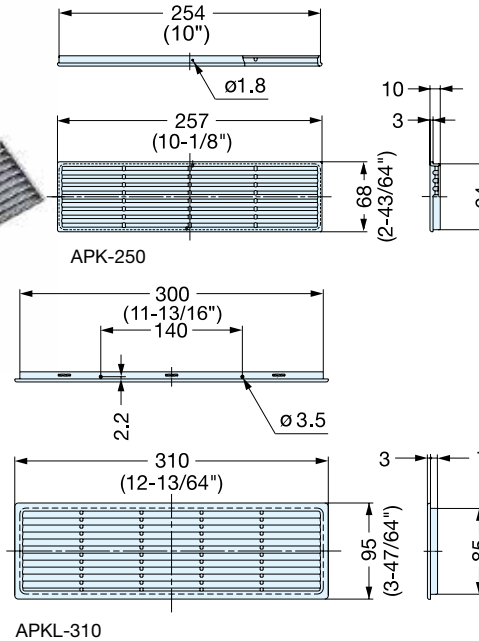

Please specify the finish when ordering.

Item No.	Weight (g)	Box (pcs)	Carton (pcs)
APK-250	57	20	160
APKL-310	100	10	80

Material	Finish
ABS	Black (BLK)/Brown (BRN)/Ivory (IVY)/Chrome (CR)-APK-250 type only

# VENTILATOR



## APD, APDL



• ABS ventilator.

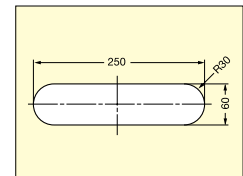
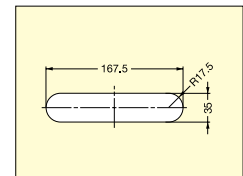
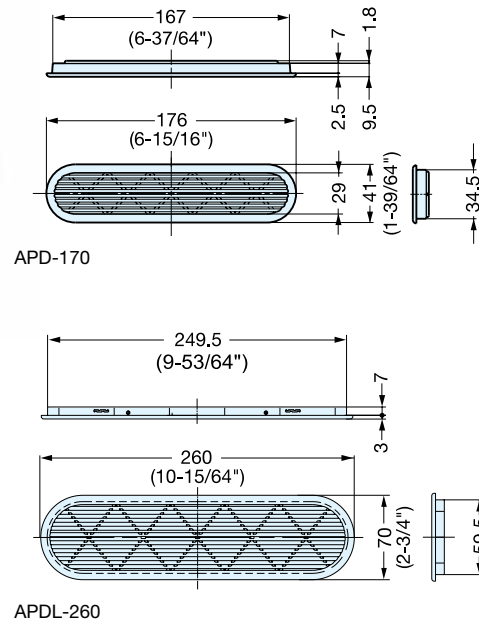

Please specify the finish when ordering.

Item No.	Weight (g)	Box (pcs)	Carton (pcs)
APD-170	22	40	320
APDL-260	60	10	80

Material	Finish
ABS	Black (BLK)/Brown (BRN)/Ivory (IVY)/Chrome (CR)-APD-170 type only

# RECESSED PULL (W/VENTILATOR)



## UTA-105

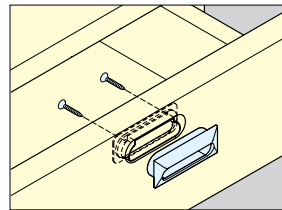
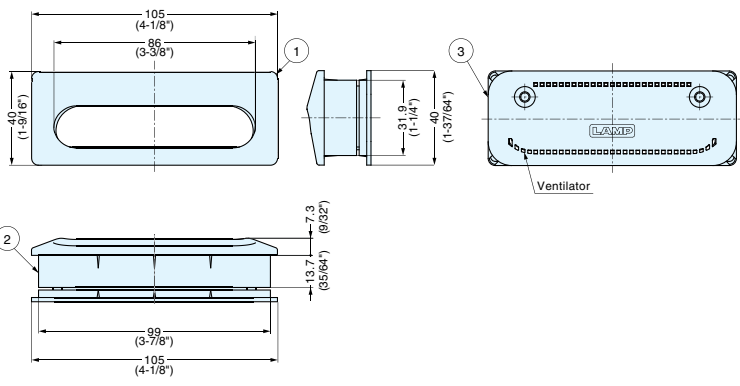
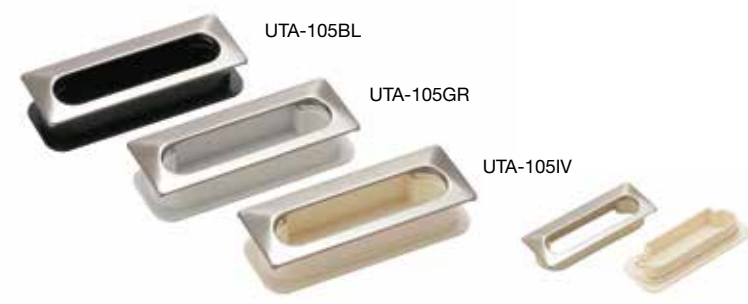

Installation

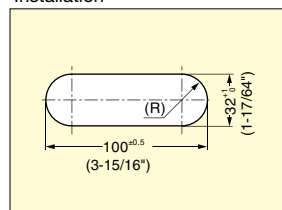

Panel Cut Out Dimensions

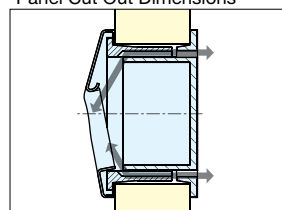

Air Circulation

Item No.	Panel Thickness	Weight (g)	Box (pcs)	Carton (pcs)
UTA-105BL	18~25 mm (11/16"~1")	40	15	150
UTA-105GR				
UTA-105IV				

No.	Material	Finish
①	304 Stainless Steel	Satin
②	ABS	Black (BL)/Grey (GR)/Ivory (IV)
③		

# ALUMINUM VENTILATOR



## APK-K



- Aluminum alloy ventilators with simple design.
- Removeable vent covers and cable grommets for easy cleaning.

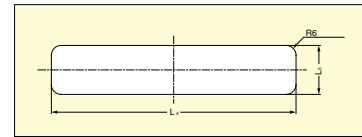
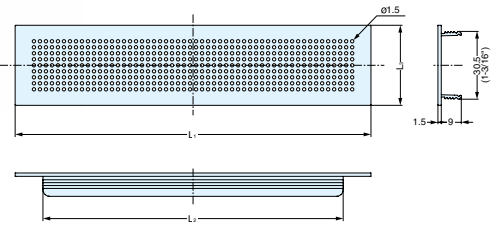

Cut Out Dimensions

Item No.	Material	Material	L1	L2	L3	L4	L5	Weight (g)	Box (pcs)	Carton (pcs)
APK-K160A-SL	Aluminum	Silver	160	135	36	150	30.5 (1-13/64")	27	30	180
APK-K160A-BL		Black	(6-19/64")	(5-5/16")		(5-29/32")				
APK-K210A-SL		Silver	212	187	200	70.0 (2-3/4")	37			
APK-K210A-BL		Black	(8-11/32")	(7-23/64")				(7-7/8")		
APK-K400A-SL		Silver	400 (15-3/4")	375 (14-49/64")	60 (2-23/64")	390 (15-23/64")	50.0 (1-31/32")	95	20	80
APK-K400A-BL		Black								
APK-K400A-DBR		Brown								
APK-K400A-WT		White								
APK-K400AW-SL		Silver	80 (3-5/32")	70.0 (2-3/4")	130					
APK-K400AW-BL		Black								
APK-K400AW-DBR		Brown								
APK-K400AW-WT		White								



# VENTILATOR



# APK-KH

- ABS ventilator.
- Interchangeable vent covers.



Vent Covers

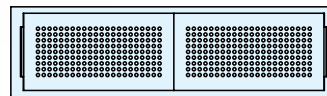
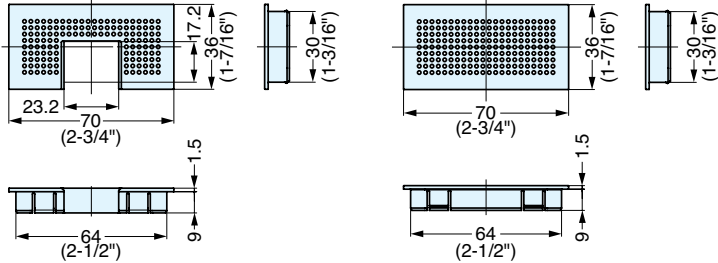

APK-KHA 152P

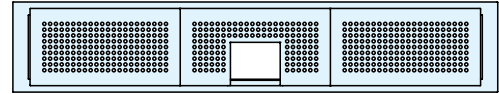

APK-KHW 226P

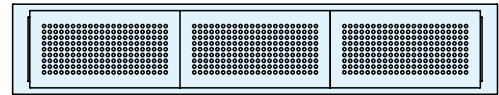

APK-KHA 226P

Bezel

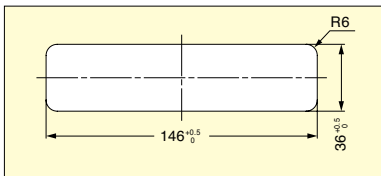
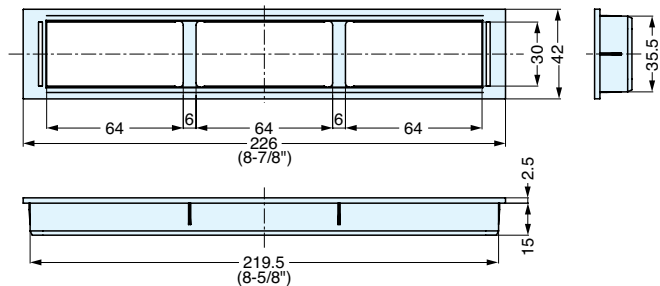
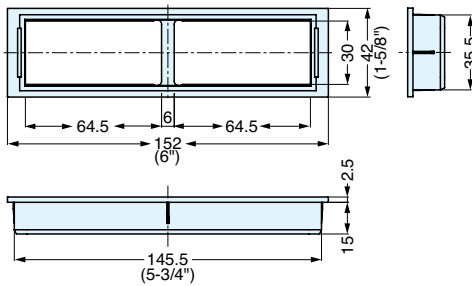

Cut Out Dimensions

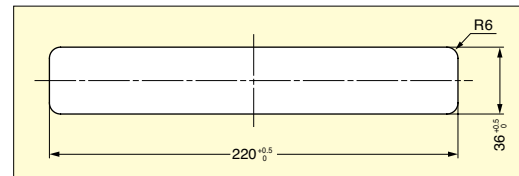

Cut Out Dimensions

Item No.	Material	Finish	Weight (g)	Box (pcs)	Carton (pcs)
APK-KHA152P-WT	ABS	White	39	20	200
APK-KHA152P-BL		Black			
APK-KHA152P-BR		Brown			
APK-KHW226P-WT		White	46		
APK-KHW226P-BL		Black			
APK-KHW226P-BR		Brown			
APK-KHA226P-WT		White			
APK-KHA226P-BL		Black			
APK-KHA226P-BR		Brown			

# VENTILATOR W/CABLE GROMMET



## APD-KH

ENCLOSURE COMPONENTS

VENTILATOR WITH CABLE GROMMET

• ABS ventilator.

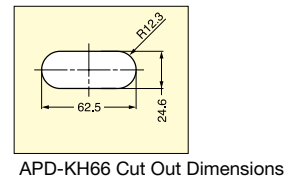
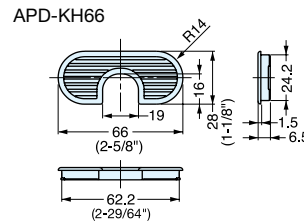
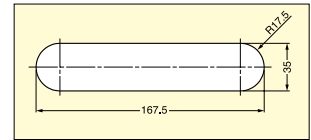
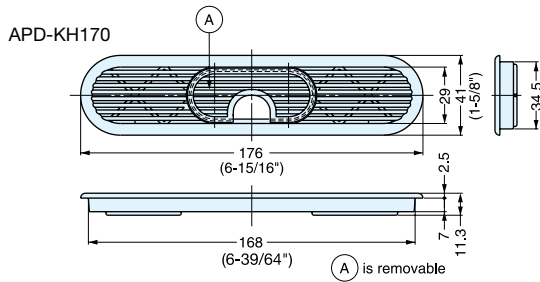
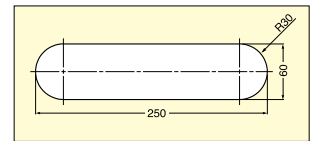
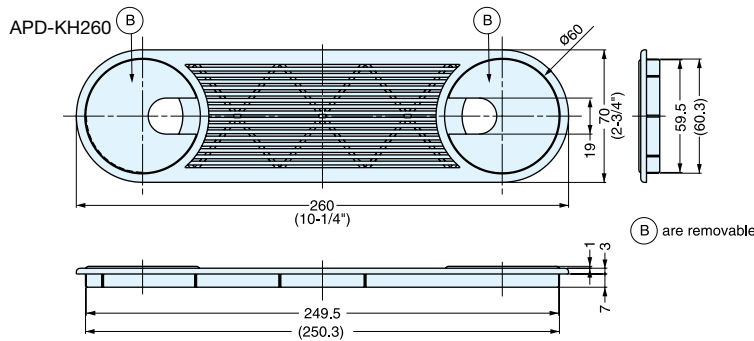
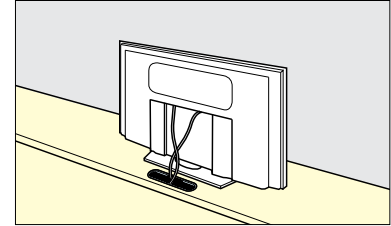

Item No.	Material	Finish	Weight (g)	Box (pcs)	Carton (pcs)
APD-KH66-CR	ABS	Chrome	3.7	100	500
APD-KH66-IV		Ivory			
APD-KH66-BL		Black	3.0		
APD-KH66-BR		Brown			
APD-KH66-WT		White			
APD-KH170-CR		Chrome	24.0		
APD-KH170-IV		Ivory			
APD-KH170-BL		Black			
APD-KH170-BR		Brown	20.0		
APD-KH170-WT		White			
APD-KH260-IV		Ivory		55.0	10
APD-KH260-BL		Black			
APD-KH260-BR		Brown			

# CABLE GROMMET



## S445, S51, S60, S76, S89

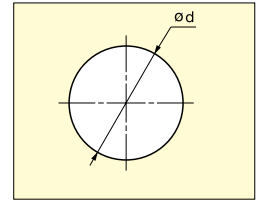
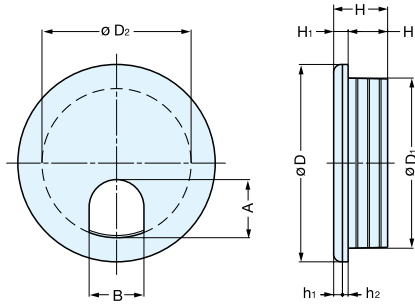

Bore Dimensions

ENCLOSURE COMPONENTS

CABLE GROMMETS

Please specify the finish when ordering.

Material	Finish
ABS	White (WHT)/Black (BLK)

Item No.	D	D <sub>1</sub>	D <sub>2</sub>	H	H <sub>1</sub>	H <sub>2</sub>	h <sub>1</sub>	h <sub>2</sub>	A	B	d	Weight (g)	Box (pcs)	Carton (pcs)
S445	45.0 (1-25/32")	38.8 (1-17/32")	34.0	19.7	3.3	16.4	2.0	1.3	16.7	12.5	39	8.7	100	1200
S51	51.0 ( 2" )	44.8 ( 1-3/4" )	39.7	19.9	3.6	16.3		1.6	19.0	15.5	45	11.1		800
S60	60.5 ( 2-3/8" )	48.8 ( 1-59/64" )	44.0	19.8		16.2	2.6	1.6	20.8	19.0	49	13.7	50	600
S76	76.5 ( 3-1/64" )	64.8 ( 2-17/32" )	59.0	20.3	4.2	16.1			2.5	21.5	21.5	65		21.8
S89	89.4 ( 3-33/64" )	76.8 ( 3-1/64" )	71.4	20.6	4.1	16.5	2.6	1.5	25.0	22.0	77	30.3		250

# CABLE GROMMET



## S165-76

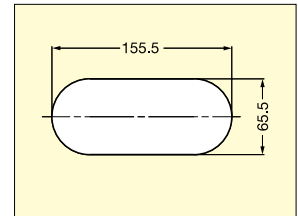

Bore Dimensions

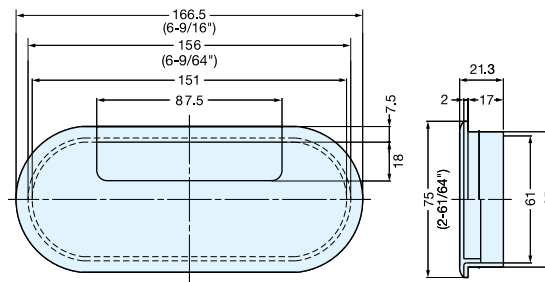

Please specify the finish when ordering.

Item No.	Weight (g)	Box (pcs)	Carton (pcs)	Material	Finish
S165-76	47.7	150	1500	ABS	White (WHT)/Black (BLK)

# CABLE GROMMET



V60, V80



V60/WHT

V60/BLK

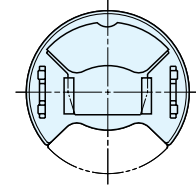
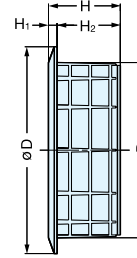
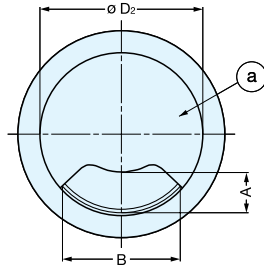

Backside of Cap (a)  
(When lid open)

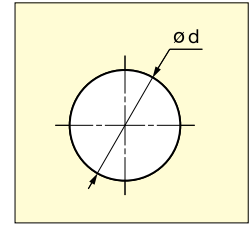

Bore Dimensions

Material	Finish
Plastic	White (WHT)/Black (BLK)

Please specify the finish when ordering.

Item No.	D	D <sub>1</sub>	D <sub>2</sub>	H	H <sub>1</sub>	H <sub>2</sub>	A	B	d	Weight (g)	Box (pcs)	Carton (pcs)
V60	72 ( 2-27/32" )	61.0 ( 2-13/32" )	56.7	25	3	22	14	41	60.5	25.5	90	900
V80	92 ( 3-5/8" )	80.5 ( 3-11/64" )	77.0					50	80.0	39.0	88	880

ENCLOSURE COMPONENTS

CABLE GROMMETS

# CABLE GROMMET



V2000



V-2000/BLK

V-2000/WHT

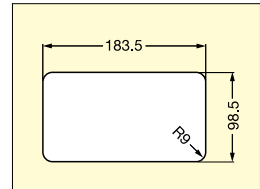
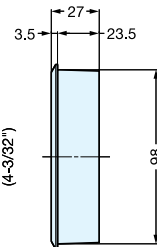
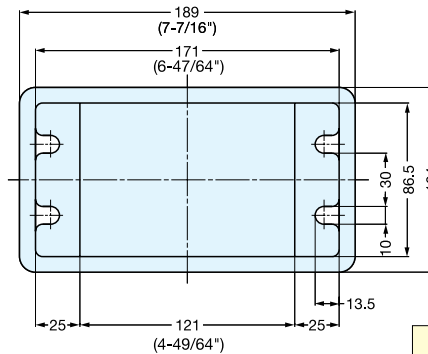
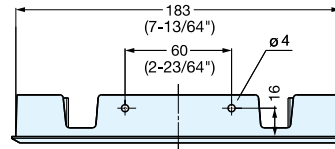

Bore Dimensions

Please specify the finish when ordering.

Item No.	Weight (g)	Box (pcs)	Carton (pcs)	Material	Finish
V2000	102	33	330	Plastic	White (WHT)/Black (BLK)

# CABLE GROMMET (VAPOR PROTECTION)



## WSM-150



- Cable grommet with oil/vapor barrier.
  - Grommet cover can be installed/uninstalled without tools.
  - Cable grommet designed for variety of manufacturing tool and equipment enclosures.
  - IP54F rated - limits the ingress of dust and fluid sprays.
  - Accommodates cables up to Ø30 mm.
  - Gasket can be adjusted to accommodate multiple cables.
  - Wiring maintenance can be done without tools.
  - WSM-10 cable management bracket optional.
- For best performance, the grommet should be installed at the base of the enclosure.

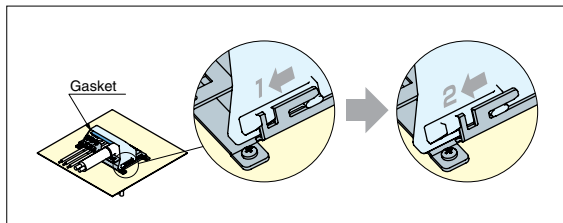
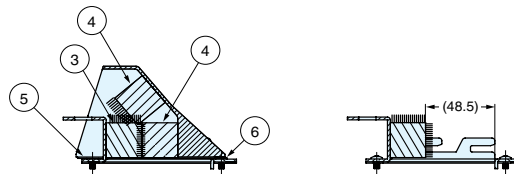
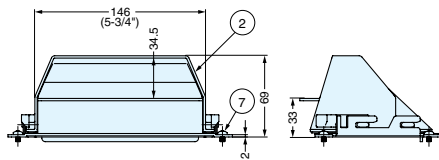
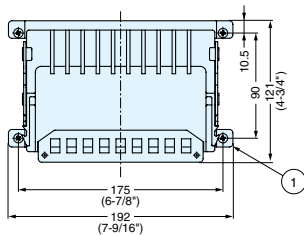
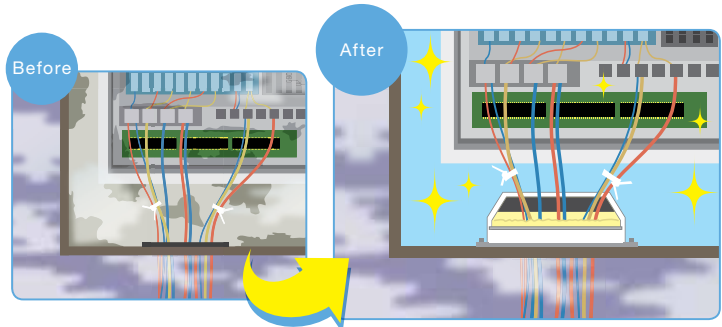
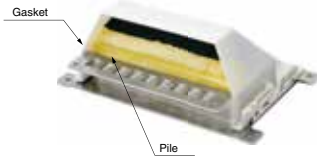

WSM-150

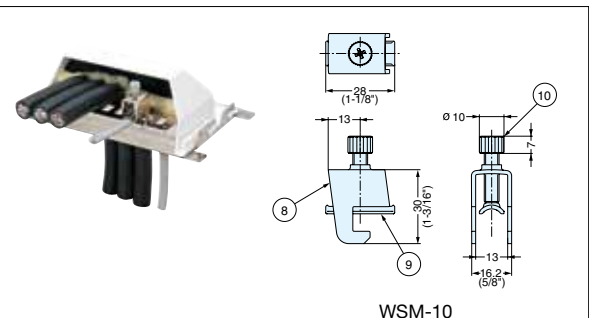

WSM-10

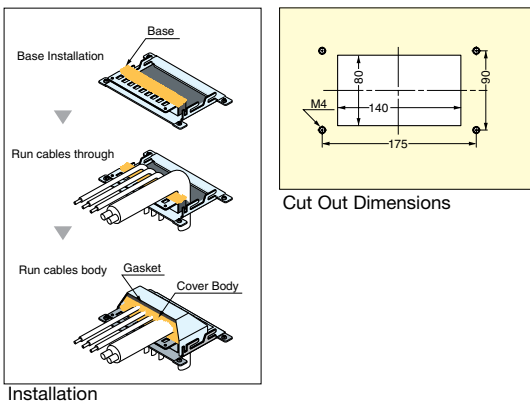

Installation

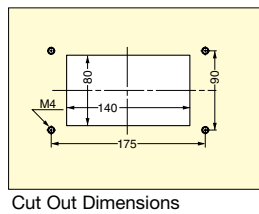

Cut Out Dimensions

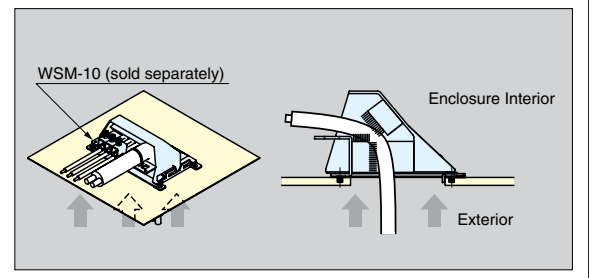

No.	Part Name	Material	Finish
①	Body	Steel	Nickel
②	Cover	ABS	White
③	Gasket A	NBR rubber+pile fabric	Black
④	Gasket B		
⑤	Gasket C	NBR rubber	Black
⑥	Gasket D		
⑦	Screw	Stainless Steel	Plane

Item No.	Description	Weight (g)
WSM-150	Cable Grommet	438
WSM-10	Wire management bracket	23

# CABLE GROMMET (DUST PROTECTION)



WSD

ENCLOSURE COMPONENTS

CABLE GROMMET (DUST PROTECTION)



- Cable grommet with dust barrier.
- Easy installation without tools required.
- Cable grommet designed for variety of manufacturing tool and equipment enclosures.
- IP5X rated - limits the ingress of dust.
- Pile Fabric and NBR rubber gaskets creates better seal for use with various size cables.
- Removeable guide plate for easy access to cables.
- Accommodates cables up to Ø20 mm.
- 70 - 3 each Ø20 mm / 140 - 6 each Ø20 mm / 280 - 8 each Ø20 mm
- Gasket can be adjusted to accommodate multiple cables.
- WSM-10 cable management bracket optional.
- WSD-B bracket optional.

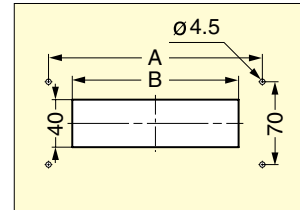

Cut Out Dimensions

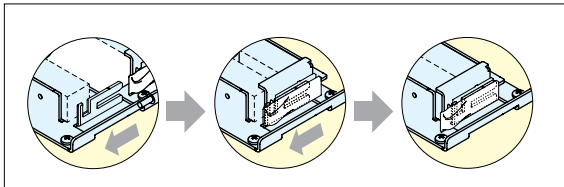
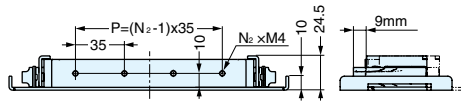
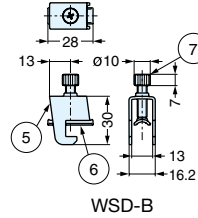
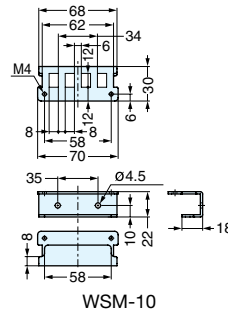
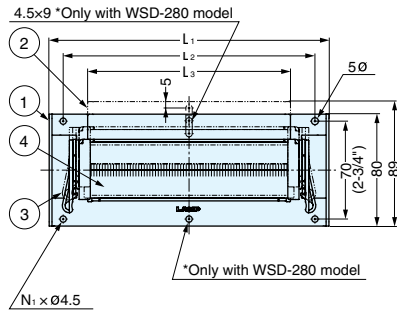

2nd step installation process adjusts to different sized wires.

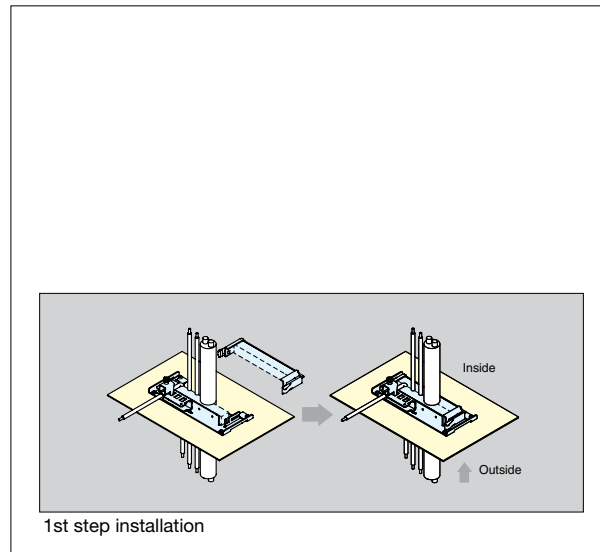

1st step installation

No.	Part Name	Material	Finish
①	Base Plate	Steel	Nickel
②	Guide Plate		
③	Joint	Polyacetal	White
④	Gasket	NBR Rubber +Pile Fabric	Black
⑤	WSM-10 body	Steel	Nickel
⑥	Pressure Plate		
⑦	Bolt		

Item No.	Description	Weight (g)
WSD-B	Wire management bracket	61
WSM-10	Wire bracket	23

Item No.	L <sub>1</sub>	L <sub>2</sub>	L <sub>3</sub>	P	N <sub>1</sub>	N <sub>2</sub>	A	B	Weight (g)
WSD-70	130 ( 5-1/8" )	110 ( 4-21/64" )	75 ( 2-61/64" )	35	3	2	110	70	298
WSD-140	200 ( 7-7/8" )	180 ( 7-3/32" )	145 ( 5-45/64" )	105		4	180	140	433
WSD-280	340 ( 13-25/64" )	320 ( 12-19/32" )	285 ( 11-7/32" )	245	4	8	320	280	793

**MULTI-PURPOSE LID (W/DAMPER)**



**AZ-GD230/HL, AZ-SD310/HL**



AZ-GD230/HL



- Soft and slow closing movement with a unique damper mechanism.
- 304 Stainless Steel lid and frame.
- Soft closing dustbin cover.

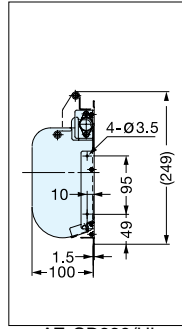

AZ-GD230/HL

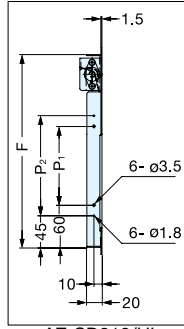

AZ-SD310/HL

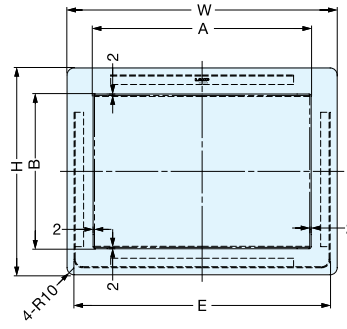

Cut Out Dimensions

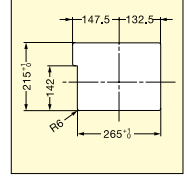

AZ-GD230/HL

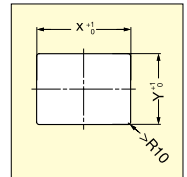

AZ-SD310/HL

Material	Finish
304 Stainless Steel	Satin

Item No.	A	B	W	H	E	F	P <sub>1</sub>	P <sub>2</sub>	X	Y	Weight (kg)	Box (pcs)	Carton (pcs)
AZ-GD230/HL	234	160	308	234	-	-	-	-	-	-	1.5	1	10
AZ-SD310/HL	310	220	384	294	364	274	112	142	365	275	2.2		

**MULTI-PURPOSE LID (W/HANDLE)**



**AZ-HD230/HL, 310/HL**



- Easy to open with the handle.
- No need to put hands inside enclosure.
- 304 Stainless Steel lid, frame, and handle.

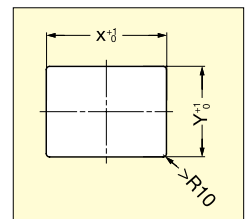
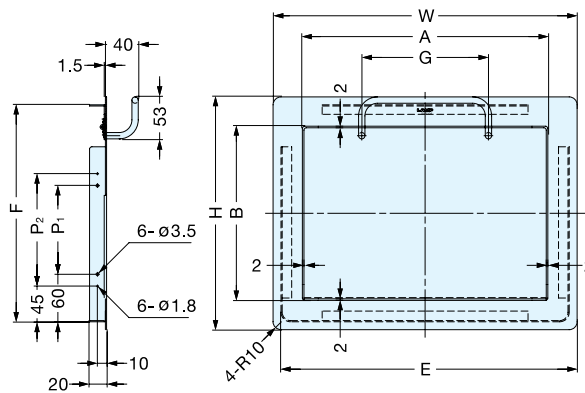

Cut Out Dimensions

Material	Finish
304 Stainless Steel	Satin

Item No.	A	B	W	H	E	F	G	P <sub>1</sub>	P <sub>2</sub>	X	Y	Weight (kg)	Box (pcs)	Carton (pcs)
AZ-HD230/HL	234	160	308	234	288	214	120	60	90	289	215	1.8	1	10
AZ-HD310/HL	310	220	384	294	364	274	160	112	142	365	275	2.2		

## MULTI-PURPOSE LID (SOFT CLOSE)

STAINLESS  
304  
STEEL

## AD-KH017-HL

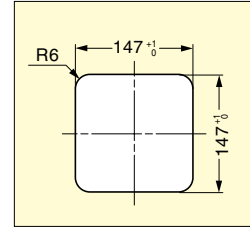
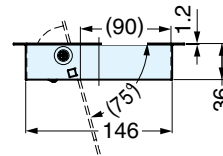
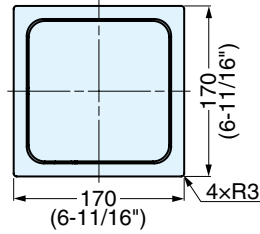
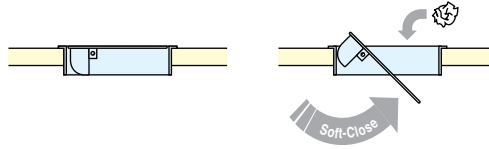

Cut Out Dimensions

- Self-leveling lid
- Soft and slow closing movement.
- For horizontal use.

Item No.	Weight (g)	Box (pcs)	Carton (pcs)
AD-KH017-HL	967	1	10

Material	Finish
304 Stainless Steel	Satin
303 Stainless Steel	
Polyacetal	
Steel	
CRC	
NBR (Rubber)	

## MULTI-PURPOSE GROMMET

STAINLESS  
304  
STEEL

## AN-KH

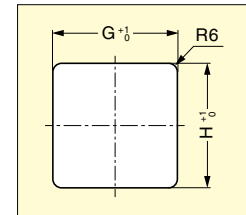
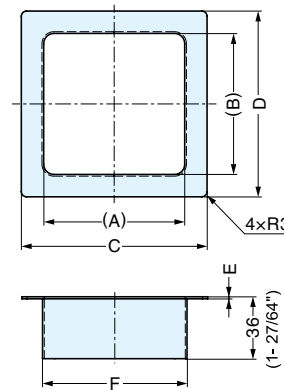

Cut Out Dimensions

- Corrosion resistant.
- Ideal for small dustbin applications.

Item No.	A	B	C	D	E	F	G	H	Weight (g)	Box (pcs)	Carton (pcs)
AN-KH005-HL	56 (2-13/64")	56 (2-13/64")	82 (3-15/64")	82 (3-15/64")	1.2	58	59	59	87	1	10
AN-KH008-HL	82 (3-15/64")	82 (3-15/64")	108 (4-1/4")	108 (4-1/4")		84	85	85	126		
AN-KH015-HL	144 (5-43/64")	144 (5-43/64")	170 (6-11/16")	170 (6-11/16")		146	147	147	217		
AN-KH017											

Material	Finish
304 Stainless Steel	Satin



# MULTI-PURPOSE LID (SOFT CLOSE)

STAINLESS  
304  
STEEL

## AD-GD

- Soft and slow closing movement with a built-in damper mechanism.
- Horizontal use only.

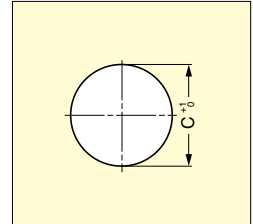
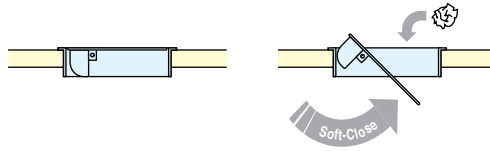

Cut Out Dimensions

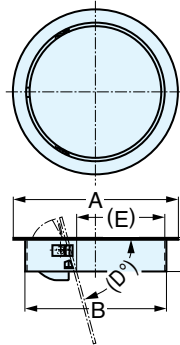

Material	Finish
304 Stainless Steel	Satin
303 Stainless Steel	
Polyacetal	
Steel	
CRC	
NBR (Rubber)	

Item No.	A	B	C	D	E	Weight (g)	Box (pcs)	Carton (pcs)
AD-GD011-HL	136 (5-23/64")	106 (4-11/64")	107 (4-7/32")	87 (3-27/64")	62 (2-7/16")	460	1	10
AD-GD015-HL	170 (6-11/16")	146 ( 5-3/4" )	147 (5-25/32")	75 (2-61/64")	90 (3-35/64")	1000		

# MULTI-PURPOSE LID

STAINLESS  
304  
STEEL

## AD-DH015-HL

- Self-leveling lid.
- Horizontal use only.

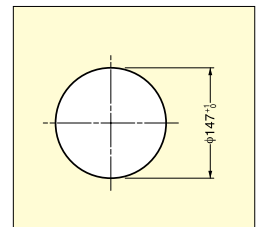
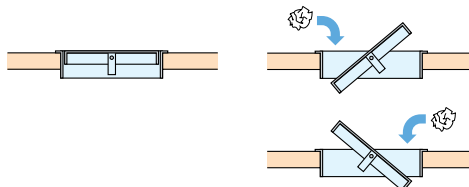

Cut Out Dimensions

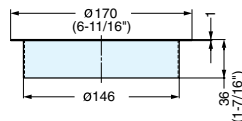
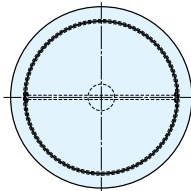

Item No.	Weight (g)	Box (pcs)	Carton (pcs)	Material	Finish
AD-DH015-HL	554	1	10	304 Stainless Steel	Satin

## MULTI-PURPOSE LID (DOUBLE DOOR)



## AZ-DD310/HL



- Synchronized doors allow for easy opening.
- 304 Stainless Steel lid and frame.

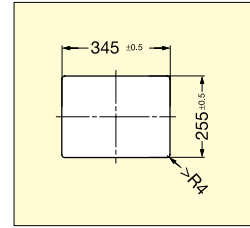
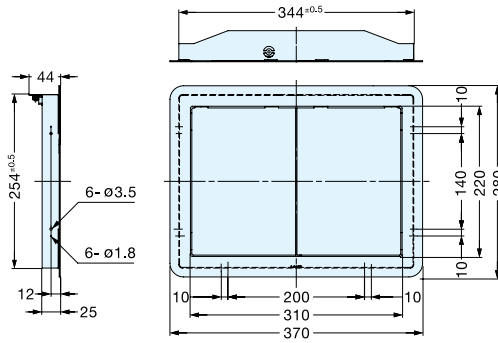

Cut Out Dimensions

Item No.	Weight (kg)	Box (pcs)	Carton (pcs)	Material	Finish
AZ-DD310/HL	2.2	1	10	304 Stainless Steel	Satin

## MULTI-PURPOSE LID (SQUARE BEZEL)



## AZ-ND



AZ-ND230HL

AZ-ND310HL

- Corrosion resistant.
- 304 Stainless Steel

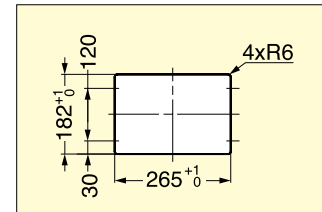
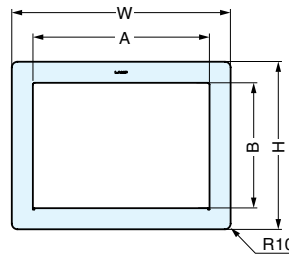
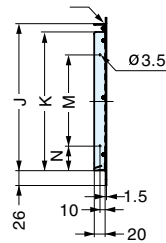
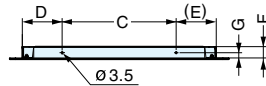

AZ-ND230HL Cut Out Dimensions

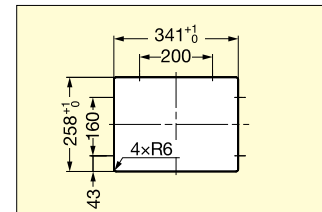

AZ-ND310HL Cut Out Dimensions

Item No.	Material	Finish	A	B	W	H
AZ-ND230HL	Stainless Steel (SUS304)	Satin	234 ( 9-7/32" )	160 (6-19/64")	308 (12-1/8")	234 ( 9-7/32" )
AZ-ND310HL			310 (12-13/64")	220 (8-21/32")	384 (15-1/8")	394 (15-33/64")

Item No.	C	D	E	F	G	J	K	M	N	Weight (kg)
AZ-ND230HL	-	-	-	-	-	-	170	120	30	0.72
AZ-ND310HL	200	70	70	20	10	257	243	160	43	1.05

# MULTI-PURPOSE GROMMET



## AN-DH, AN-LH

- Corrosion resistant.
- Wide range of sizes and finishes.

AN-DH005-HL



AN-DH008-GP

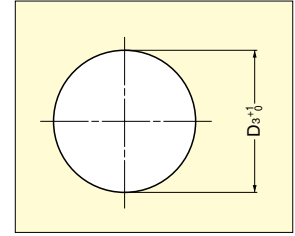

Cut Out Dimensions

AN-DH011-MR



AN-DH015-HL



AN-DH

AN-LH

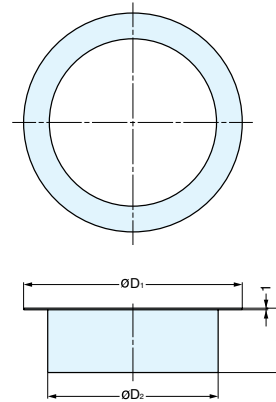
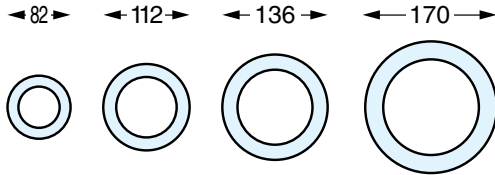

ENCLOSURE COMPONENTS

MULTI-PURPOSE GROMMET

Item No.	A	D <sub>1</sub>	D <sub>2</sub>	D <sub>3</sub>	Material	Finish	Weight (g)	
AN-DH005-GP	36	82 (3-15/64")	58 (2-9/32")	59 (2-21/64")	Stainless Steel (SUS 304)	Gold	66	
AN-DH005-MR						Mirror		
AN-DH005-HL						Satin		
AN-DH008-GP		112 (4-13/32")	82 (3-15/64")	83 (3-17/64")		Gold		107
AN-DH008-MR						Mirror		
AN-DH008-HL						Satin		
AN-DH011-GP	40	136 (5-23/64")	106 (4-11/64")	107 (4-7/32")		Gold	137	
AN-DH011-MR						Mirror		
AN-DH011-HL						Satin		
AN-DH015-GP	36	170 (6-11/16")	146 (5-3/14")	147 (5-25/32")		Gold		182
AN-DH015-MR						Mirror		
AN-DH015-HL						Satin		

Item No.	A	D <sub>1</sub>	D <sub>2</sub>	D <sub>3</sub>	Material	Finish	Weight (g)	
AN-LH005-GP	22	82 (3-15/64")	58 (2-9/32")	59 (2-21/64")	Stainless Steel (SUS 304)	Gold	50	
AN-LH005-MR						Mirror		
AN-LH005-HL						Satin		
AN-LH008-GP		112 (4-13/32")	82 (3-15/64")	83 (3-17/64")		Gold		77
AN-LH008-MR						Mirror		
AN-LH008-HL						Satin		
AN-LH011-GP		136 (5-23/64")	106 (4-11/64")	107 (4-7/32")		Gold	92	
AN-LH011-MR						Mirror		
AN-LH011-HL						Satin		
AN-LH015-GP		170 (6-11/16")	146 (5-3/14")	147 (5-25/32")		Gold		122
AN-LH015-MR						Mirror		
AN-LH015-HL						Satin		

# CORNER CONNECTOR

# PJ-100

ENCLOSURE COMPONENTS

CORNER CONNECTORS



- Simplified slide-in design saves frame assembly time.
- Integral clamps eliminate need to align separate nuts and bolts.
- Tighten only one screw to connect frames.
- PJ-100 is designed for 10 mm single slot frames.
- M4 threaded hole provided on PJ-100T for panel installation.

PJ-100T (For 10mm slot frame)

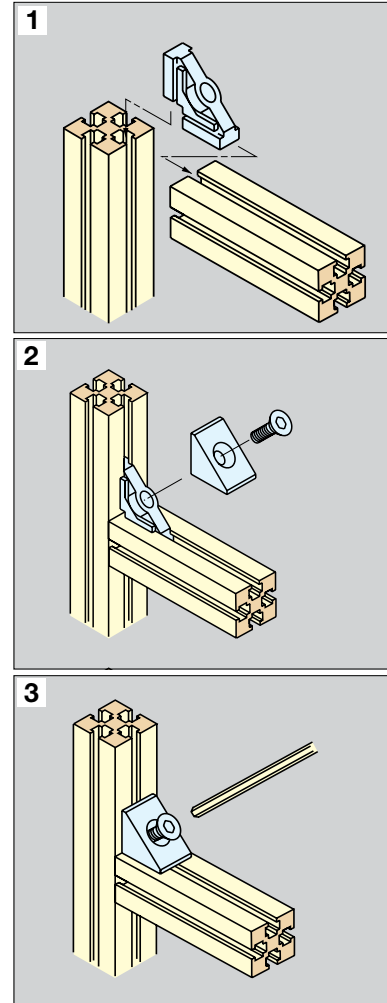
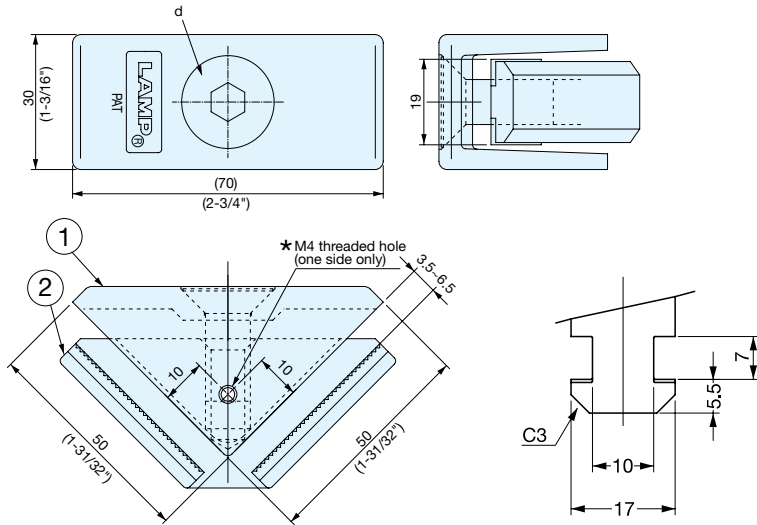

No.	Part Name	Material	Finish
①	Cover	Aluminum Alloy	Silver
②	Clamp	Zinc Alloy	Yellow Zinc Chromate

Item No.	*Threaded Hole	d	Weight (g)	Box (pcs)	Carton (pcs)
PJ-100	Without	M10×25	171	15	60
PJ-100T	M4				

# DROP-IN TYPE CORNER CONNECTOR

# PJ-60A, PJ-80A



- Unique drop-in design saves frame assembly time.
- Automatic self-aligning, just tighten screw to connect frames.
- Ideal for assemblies where slide-in method is not practical.
- M4 threaded hole provided on AT type for panel installation.
- PJ-60A is designed for 6 mm single slot frames.
- PJ-80A is designed for 8 mm single slot frames.

PJ-60AT (For 6mm slot frame)

PJ-80AT (For 8mm slot frame)

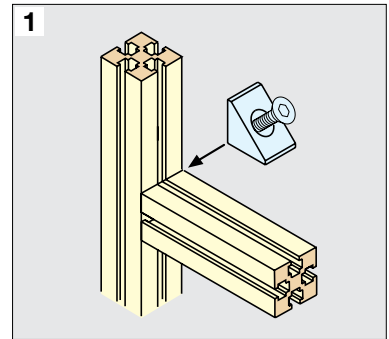
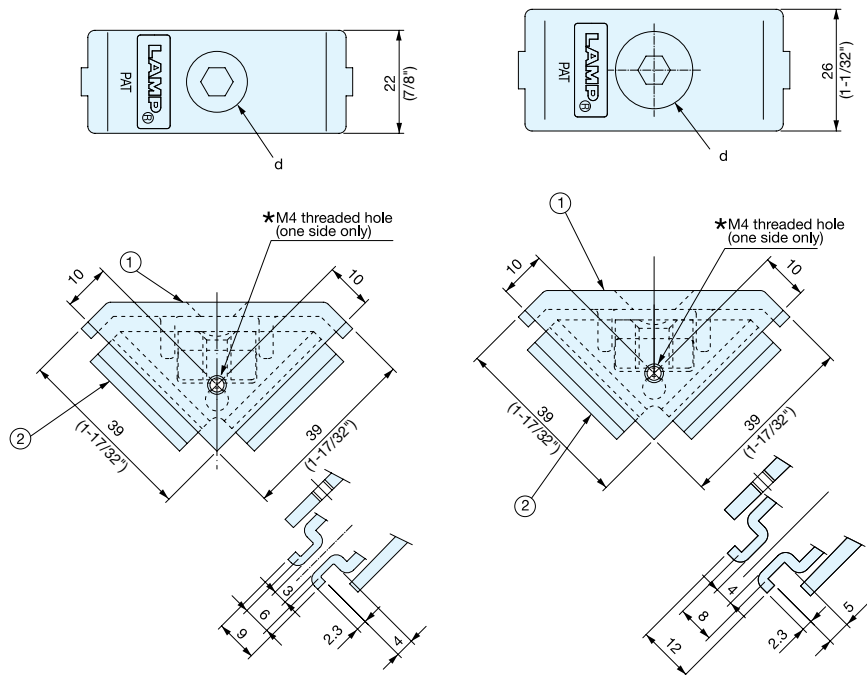

1. Simply insert PJ fastener into the slot.

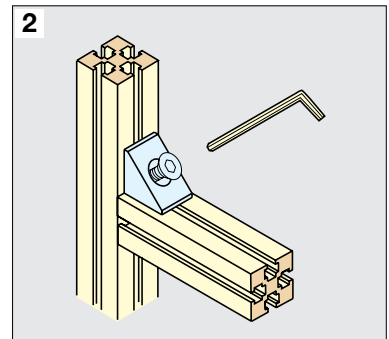

2. Tighten flat head screw with allen key.

No.	Part Name	Material	Finish
①	Cover	Aluminum Alloy	Silver
②	Clamp	Steel	Yellow Zinc Chromate

Item No.	*Threaded Hole	d	Weight (g)	Box (pcs)	Carton (pcs)
PJ-60A	Without	M6 × 16	36	40	400
PJ-60AT	M4				
PJ-80A	Without	M8 × 16	96	20	240
PJ-80AT	M4				