

HANDLE

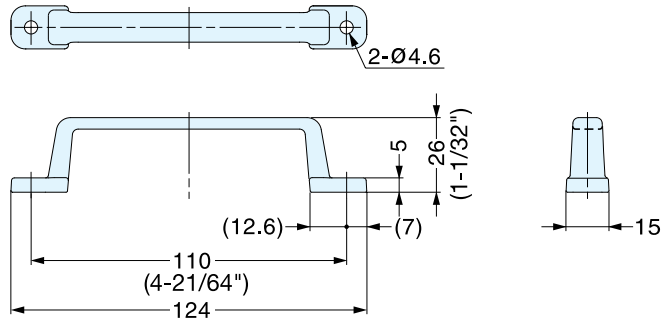

FT-110S



Item No.	Weight (g)	Box (pcs)	Carton (pcs)	Material	Finish
FT-110S	60	50	200	304 Stainless Steel	Satin

HANDLE



FT-65, 80, 100

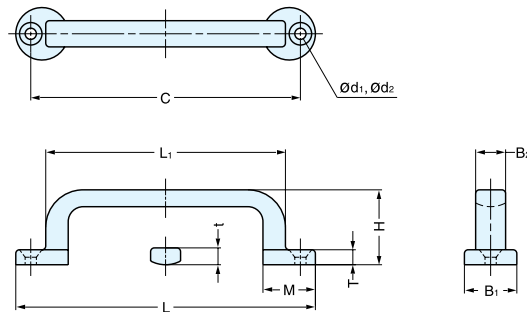

Material	Finish
304 Stainless Steel	Mirror

Item No.	L	L1	C	B1	B2	H	T	t	M	d1	d2	Weight (g)	Box (pcs)	Carton (pcs)	Screw
FT-65	65	47	57 (2-1/4")	13	7	16 (5/8")	3.5	4.0	13	3.3	6.4	19	40	480	3.1 × 16
FT-80	80	61	72 (2-27/32")	14	8	20 (25/32")	4.0	4.5	14		6.4	32	30	360	
FT-100	100	75	88 (3 -15/32")	18	10	25 (63/64")	5.0	5.5	18		4.1	8.0	58	20	

HANDLE



FT-120, 150

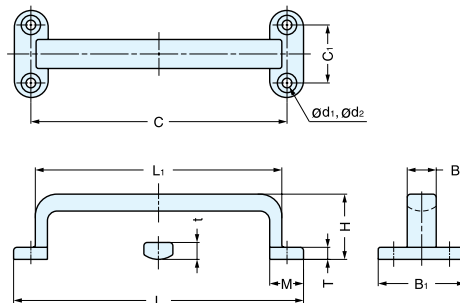

Material	Finish
304 Stainless Steel	Mirror

Item No.	L	L1	C	C1	B1	B2	H	T	t	M	d1	d2	Weight (g)	Box (pcs)	Carton (pcs)	Screw
FT-120	120	102	106 (4-11/64")	24	36	12	27 (1-1/16")	5	7	14	4.1	8.0	105	10	120	3.8 × 20
FT-150	150	126	132 (5-3/16")	30	45	15	33 (1-19/64")	6	8	18	5.3	10.4	191	5	40	5.1 × 25